



Micron Power Resistors

MHS

Chassis-Fixed Heat Dissipation (Efficient) Types

MHR

Type N

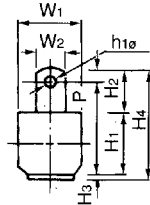
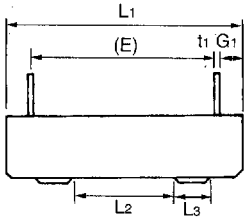

Derating Curve

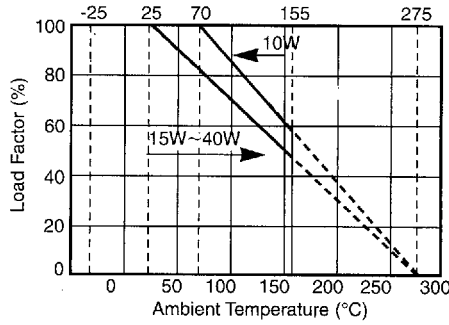

Temperature Rise (ref.)

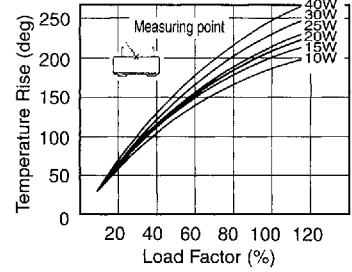

Rated power (W)	Dimensions (mm)													
	L1	L2	L3	W1	W2	H1	H2	H3	H4	P1	(E)	G1	t1	H1ø
10	48±1.5	25±1	4.5	9.5±1.0	5	9.5±1.0	6+1.5	0.8	16.5 ^{+1.5} _{-1.0}	2.5	36	5.5 ⁺² ₋₁	0.4	2
15	48±1.5	25±1	7	12.5±1.2	6	12.5±1.2	7.5+2	1.0	21 ^{+2.0} _{-1.0}	3	34	6.5 ⁺² ₋₁	0.5	2.5
20	63.5±2	25±1	7	12.5±1.2	6	12.5±1.2	7.5+2	1.0	21 ^{+2.0} _{-1.0}	3	49.5	6.5 ⁺² ₋₁	0.5	2.5
25	63.5±2	25±1	8	16±1.2	7.5	16±1.2	12+2	1.0	29 ^{+2.5} _{-1.5}	3.5	46.5	8 ^{+2.5} ₋₁	0.5	3
30	75±2.5	40±1.2	10	19±1.5	7.5	19±1.5	10+2	1.0	30 ^{+2.5} _{-1.5}	3.5	56	9 ⁺³ ₋₁	0.5	3
40	90±2.5	40±1.2	10	19±1.5	7.5	19±1.5	10+2	1.0	30 ^{+2.5} _{-1.5}	3.5	71	9 ⁺³ ₋₁	0.5	3

Type A

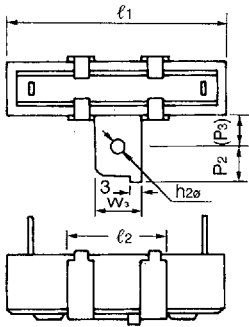

Type B (10W, 20W, 25W, 40W)

(15W, 30W)

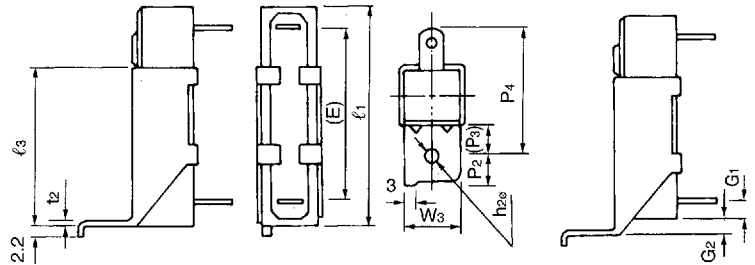

Rated power (W)	Dimensions (mm)											Resistance range (Ω)			Weight (g)
	l1	l2	l3	W3	P2 (P3)	P4	G1	G2	t2	h2ø	MHS		MHR		
											Standard	UL	Standard		
10	A	48±1.5	24	12±0.2	6	8	—	5.5 ⁺² ₋₁	—	0.6	4	1.0~1500	1.0~1500	200~75K	14.5
	B		36												
15	A	48±1.5	24	12±0.2	6	8	—	6.5 ⁺² ₋₁	—	0.8	4	1.0~2000	1.0~2000	510~110K	24.0
	B		43												
20	A	63.5±2	24	12±0.2	6	8	—	6.5 ⁺² ₋₁	—	0.8	4	1.0~3000	1.0~3000	510~180K	28.4
	B		43												
25	A	63.5±2	24	12±0.2	6	10	—	8 ^{+2.5} ₋₁	—	0.8	4.2	1.2~3600	1.2~3600	—	44.0
	B		43												
30	A	75±2.5	39	18±0.2	8	10	—	9 ⁺³ ₋₁	—	0.8	4.2	1.5~4300	1.5~4000	—	74.0
	B		64												
40	A	90±2.5	39	18±0.2	8	10	—	9 ⁺³ ₋₁	—	0.8	4.2	1.8~5600	1.8~5500	—	86.5
	B		64												