

# Coaxial Directional Coupler

**NEW!**  
**ZNDC-23-2G**

50Ω 23dB 800 to 2000 MHz

## Maximum Ratings

Operating Temperature	-55°C to 100°C
Storage Temperature	-55°C to 100°C
Power Input	3W Max.

## Pin Connections

INPUT	1
OUTPUT	2
COUPLED	3

## Outline Drawing

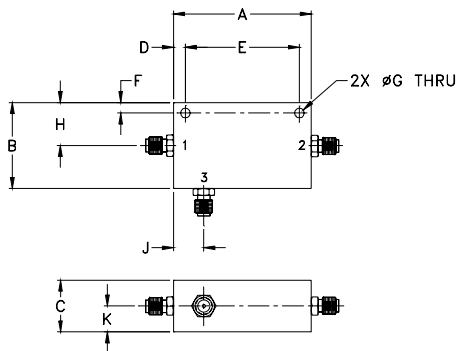

## Outline Dimensions (inch/mm)

A	B	C	D	E	F	G	H
2.00	1.25	.75	.17	1.656	.15	.140	.63
50.80	31.75	19.05	4.32	42.06	3.81	3.56	16.00

J	K	wt.
.44	.38	grams
11.18	9.65	57

## Features

- excellent insertion loss, 0.5 dB typ.
- excellent VSWR, 1.2:1 typ.
- useable over 800-2000 MHz
- very flat coupling, ±0.3 dB typ.

## Applications

- cellular
- PCS
- ISM



CASE STYLE: FM587  
PRICE: \$49.95 ea. QTY (1-9)

## Directional Coupler Electrical Specifications

FREQ. RANGE (MHz)	COUPLING (dB)		MAINLINE LOSS (dB)		DIRECTIVITY (dB)		VSWR (:1)	POWER INPUT (W)
	Nom.	Max. Flatness	Typ.	Max.	Typ.	Min.		
800-2000								
800-1000	23.2±0.5	±0.4	0.3	0.6	25	17	1.2	3
1000-1700	23.0±0.5	±0.4	0.5	0.9	22	17	1.2	3
1700-2000	22.7±0.5	±0.4	0.6	1.1	20	14	1.2	3

## Typical Performance Data

Frequency (MHz)	Insertion Loss (dB) In-Out	Coupling (dB) In-Cpl	Directivity (dB)	Return Loss (dB)		
				In	Out	Cpl
800.00	0.33	23.52	24.81	23.11	22.15	30.23
900.00	0.34	23.37	25.98	24.42	23.52	30.61
1000.00	0.36	23.23	27.31	25.52	24.59	30.96
1100.00	0.39	23.10	29.03	25.98	25.04	31.16
1300.00	0.45	22.90	34.03	24.89	24.32	32.65
1500.00	0.52	22.80	30.69	23.11	21.98	34.94
1700.00	0.60	22.79	24.47	22.07	20.06	38.33
1800.00	0.64	22.82	22.23	21.91	19.36	39.22
1900.00	0.68	22.87	20.33	21.98	18.71	37.67
2000.00	0.72	22.95	18.29	22.29	18.30	36.58

