

REV. A	AUTH. RL	DATE 9/30/02	INITIAL RELEASE	APPROVED
REV. B	AUTH. RL	DATE 11/29/05	REMOVED FUSE, DIMSTYLES AND LINETYPES UPDATED.	APPROVED

**9-PIN CONNECTOR WIRING DIAGRAM (ATTENUATOR)**

PIN#	FUNCTION
-2	INCREASE ATTENUATION
+7	INCREASE ATTENUATION
+2	DECREASE ATTENUATION
-7	DECREASE ATTENUATION
+1	END POINT INDICATOR (MAX.)
6	END POINT INDICATOR (MAX.)
-3	END POINT INDICATOR (MIN.)
8	END POINT INDICATOR (MIN.)
5	WIPER (TRACKING POT)
4	TRACKING POT
9	TRACKING POT

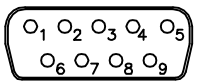

9-PIN D-SUB CONN. (F)

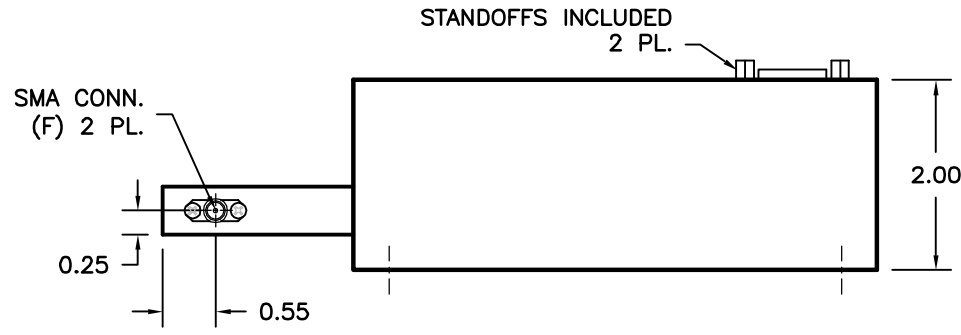
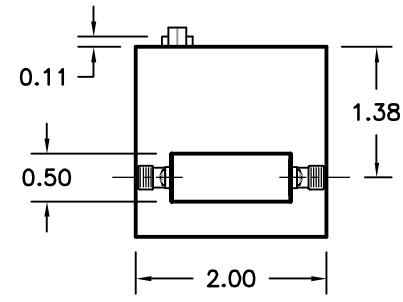
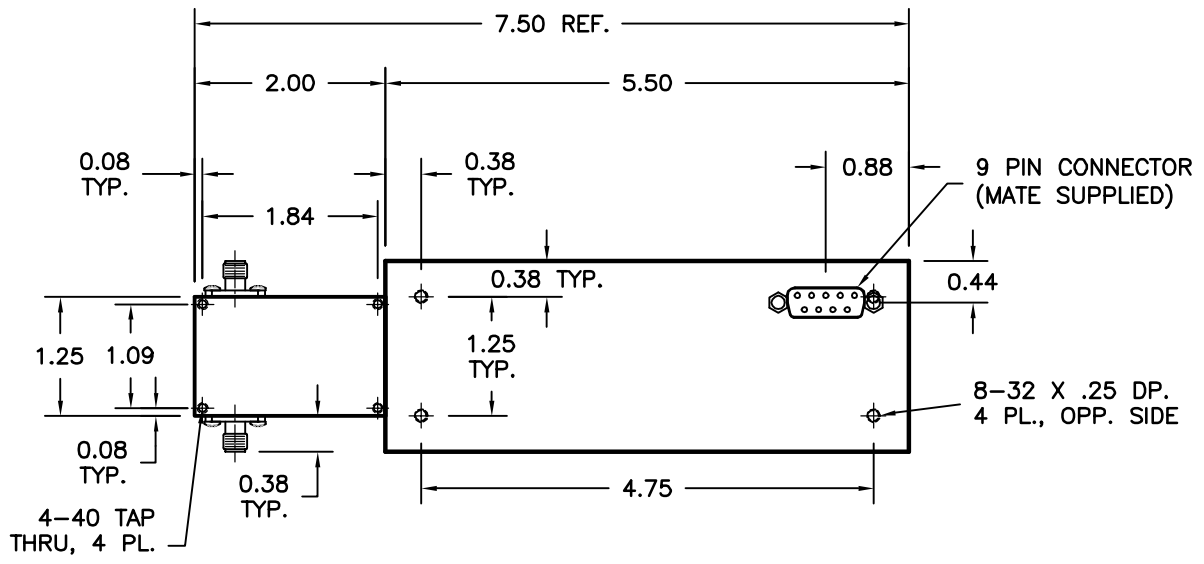

**NOTES:**

1. 10K POT USED.
2. SMA CONNECTOR IS MODIFIED TO MEET COMPONENT SPECIFICATIONS.
3. SMA CONNECTOR WILL MATE WITH 2.9MM CONNECTOR.

MATERIAL -	TREATMENT -	DRAWN R. LYNCH	DATE 9/30/02
FINISH ATM GRAY	MOD NO. AV07-XX-28	CHECKED	DATE
<b>OUTLINE, AV07 MOTOR-DRIVEN ATTENUATOR</b>		APPROVED	DATE
		CAGE CODE: OR8N4	DO NOT SCALE DWG
ADVANCED TECHNICAL MATERIALS, INC. 49 RIDER AVE., PATCHOGUE N.Y. 11772 TEL: (631) 289-0386 FAX: (631) 289-0358 http://www.atmmicrowave.com		UNLESS OTHERWISE NOTED DIMENSIONS ARE IN INCHES TOLERANCES ARE:	FRACTIONS ±1/64 DECIMALS ±.01 ANGLES ±1/2°
		SCALE 1 : 2	DWG. NO. 5206W
<small>PROPRIETARY NOTICE: THE INFORMATION IN THIS DRAWING IS PROPRIETARY AND SHALL NOT BE USED OR DISCLOSED WITHOUT THE PRIOR WRITTEN CONSENT OF ATM, INC.</small>			SHEET. 1/1 REV. B