

PRODUCT NUMBER
SEE TABLE

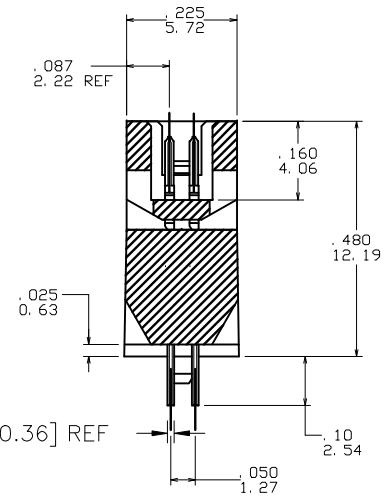

SECTION Z-Z
ROTATED 90° CW

mat'l. code				surface	tolerance	projection	product family	
-				ISO 1302	ISO 406 ISO 1101	1st angle	RIBCAGE	
ltr	ecn no	dr	date	tolerances unless otherwise specified		INCH/MM	title	
K	V61605	DLW	12/14/00	angles	.XX±.01/0.3			
L	V02780	DLW	3/9/01	linear	.xxx±.005/0.13	scale 3:1	SCOOTER 1 ASSEMBLY	
M	M05-0123	ERE	06/07/05	0°±2'	.xxxx±.0020/0.05			
N	M06-0225	ERE	06/12/06	dr	J. SHREINER	12/14/90	dwg no	
P	M06-0370	MHT	9/26/06	engr	C. TREXLER	12/14/90		sheet 1 of 2 size
R	M09-0058	CMR	4/06/09	chr	C. TREXLER	12/14/90	87434	A3
sheet				revision	R	R	type	Product Customer Drawing
index	sheet	1	2					

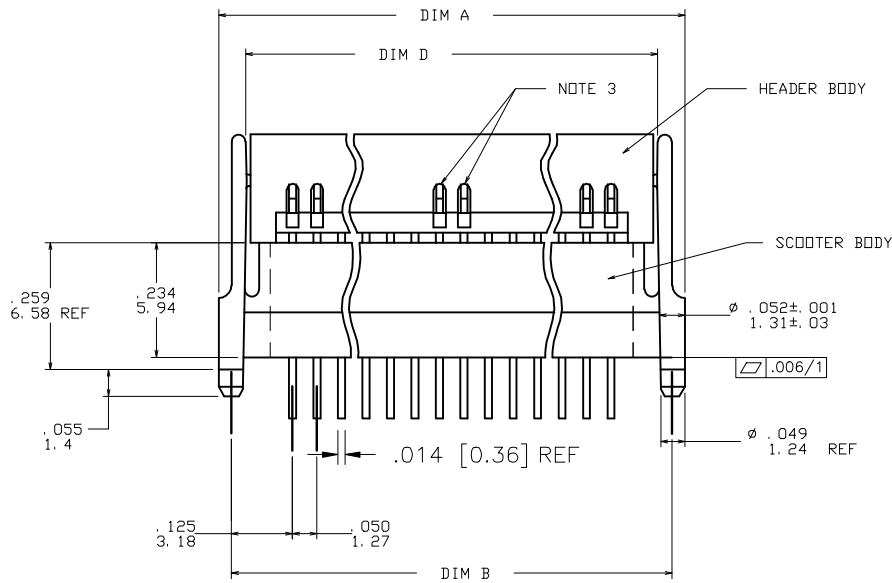
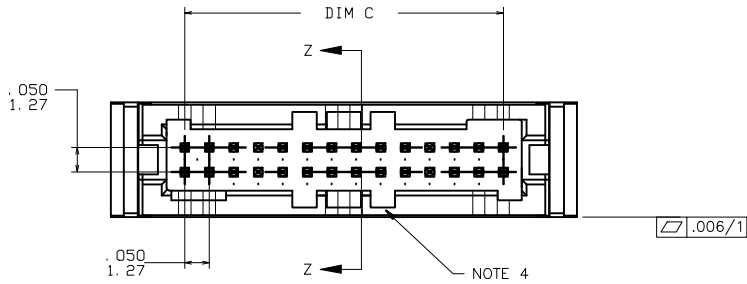

Copyright FCJ

PRODUCT NUMBER	NO OF POS	DIM A	DIM B	DIM C	DIM D
NOTE 5					
87434-115	30	1.000/25.40	.950/24.13	.700/17.78	.890/22.61
-120	40	1.250/31.75	1.200/30.48	.950/24.13	1.140/28.96
-125	50	1.500/38.10	1.450/36.83	1.200/30.48	1.390/35.31
-130	60	1.750/44.45	1.700/43.18	1.450/36.83	1.640/41.66
-135	70	2.000/50.80	1.950/49.53	1.700/43.18	1.890/48.01
-140	80	2.250/57.15	2.200/55.88	1.950/49.53	2.140/54.36
-145	90	2.500/63.50	2.450/62.23	2.200/55.88	2.390/60.71
87434-150	100	2.750/69.85	2.700/68.58	2.450/62.23	2.640/67.06

NOTES:

1. TERMINAL PLATING:
CONTACT ZONES.
30u"/.76u MIN HARD Au OVER 50u"/1.27u Ni ON CONTACT ZONES.
100u"/2.54u MIN Sn OVER 50u"/1.27u Ni IN SOLDERING ZONES.
2. HEADER BODY: GLASS FILLED THERMOPLASTIC FLAME
RETARDANT PER UL 94 V-0.
COLOR: NATURAL
HEAT DEFLECTION TEMP - 500°F
SCOOTER BODY: GLASS FILLED THERMOPLASTIC FLAME
RETARDANT PER UL 94V-0.
COLOR: NATURAL
HEAT DEFLECTION TEMP @ 264 PSI - 466°F(241°C)
PER ASTM TEST NO D64B.
3. ADDITIONAL CORING IN CENTER MANUFACTURING OPTION.
4. MOLDING FLOW RESTRICTERS QUANTITY AND LOCATION IS MANUFACTURING OPTION.
5. ADD "LF" SUFFIX AT THE END OF PART NUMBER FOR LEAD FREE OPTION.
6. THIS PRODUCT MEETS EUROPEAN UNION DIRECTIVES AND OTHER COUNTRY REGULATION AS DESCRIBED IN GS-22-008.
7. THE HOUSING WILL WITHSTAND EXPOSURE TO 260°C PEAK TEMPERATURE FOR 15 SECONDS IN A WAVE SOLDER APPLICATION WITH A 1.5mm MINIMUM THICK CIRCUIT BOARD. SEE APPLICATION NOTES/PROCEDURES IF THEY ARE AVAILABLE.

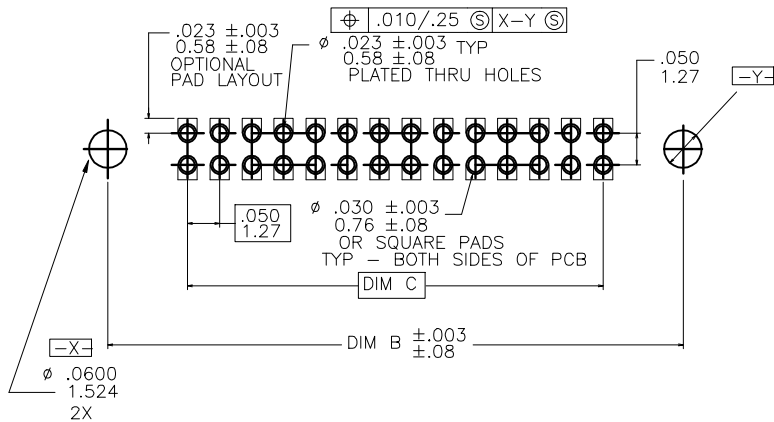

RECOMMENDED P.C.B. LAYOUT
SCALE 4/1

mat'l. code	surface	tolerance	projection	product family
-	ISO 1302	ISO 406	ISO 1101	RIBCAGE
ltr	ecp no	dr	date	title
R				SCOOTER 1 ASSEMBLY
	angles	linear	linear	INCH/MM
	0'±2'	.XX±.01/0.3	.XXX±.005/0.13	scale 3:1
		.XXXX±.0020/0.05		
	dr	J. SHREINER	12/14/90	dwg no
	engr	C. TREXLER	12/14/90	sheet 2 of 2
	chr	C. TREXLER	12/14/90	size
	appd	C. TREXLER	12/14/90	A3
sheet	revision			type
index	sheet			Product Customer Drawing