

REV A	AUTH JLE	DATE 10/15/02	INITIAL RELEASE
REV B	AUTH RL	DATE 10/30/06	FREQ. NOTES CORRECTED; ILLUSTRATION, FORMAT UPDATED.

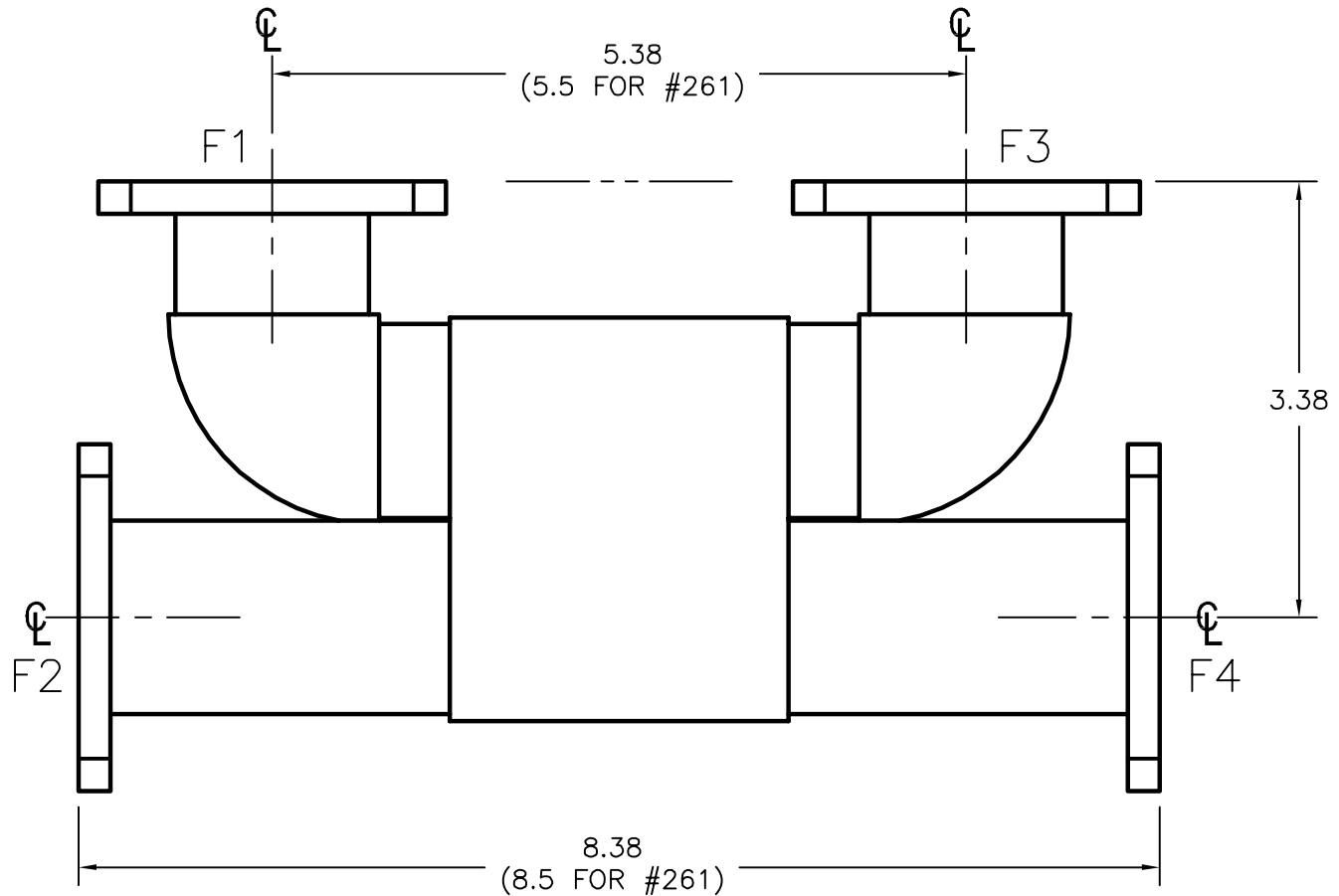

FLANGE TYPE
1 = CPRG
2 = CPRF
6 = UG COVER
7 = UG CHOKE
8 = COVER-GRV.

FREQUENCY	MODEL
5.40-6.00 GHz	137-261A-Z-F1-F2-F3-F4
5.80-6.50 GHz	137-265A-Z-F1-F2-F3-F4
6.00-7.00 GHz	137-262A-Z-F1-F2-F3-F4
6.85-7.80 GHz	137-263A-Z-F1-F2-F3-F4
7.15-8.20 GHz	137-264A-Z-F2-F2-F3-F4

NOTE: REPLACE "F1, F2, F3, & F4" NOTATION WITH NUMBER CORRESPONDING TO FLANGE TYPE DESIRED, AS SHOWN ON TABLE ABOVE.

THIRD ANGLE PROJECTION:		APPROVALS	DATE		ADVANCED TECHNICAL MATERIALS, INC. TEL: (631) 289-0363 FAX: (631) 289-0358 www.atmmicrowave.com		THE INFORMATION IN THIS DRAWING IS PROPRIETARY AND SHALL NOT BE USED OR DISCLOSED WITHOUT THE PRIOR WRITTEN CONSENT OF ATM, INC. DO NOT SCALE DWG.	
UNLESS OTHERWISE NOTED, DIMENSIONS ARE IN INCHES, TOLERANCES ARE: FRACTIONS: $\pm 1/64$ ANGLES: $\pm 1/2^\circ$		DRAWN JLE	10/15/06		OUTLINE, WR137 'Z'-STYLE COMBINER-DIVIDER (HYBRID-COUP.)			
BASIC DIMENSION	DECIMALS 2 PLACE 3 PLACE	APRVD.	MATERIAL PER ORDER		SIZE A	CAGE CODE 0R8N4	ATM DWG # 5226W	REVISION B
UNDER 6"	± 0.02 ± 0.005	TREATMENT -		SCALE NONE	MODEL # 137-26XX-Z-F1-F2-F3-F4		SHEET 1/1	
6" - 12"	± 0.03 ± 0.010	FINISH ATM STD. GRAY						
OVER 12"	± 0.06 ± 0.015							