

HE8807SG/FL

GaAlAs Infrared Emitting Diodes

HITACHI

ADE-208-998 (Z)
1st Edition
Dec. 2000

Description

The HE8807SG/FL are single heterojunction structure GaAlAs light emitting diodes with a wavelength of 880 nm.

Features

- High output, high efficiency
- Narrow spectral width
- Sharp radiation directivity (HE8807FL)
- Wide radiation directivity (HE8807SG)
- High reliability

Package Type

• HE8807SG: SG1

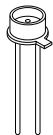

• HE8807FL: FL

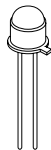

Internal Circuit

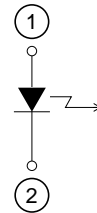

Absolute Maximum Ratings ($T_C = 25^\circ\text{C}$)

Item	Symbol	Value	Unit
Forward current	I_F	200	mA
Reverse voltage	V_R	3	V
Operating temperature	T_{opr}	-20 to +85	$^\circ\text{C}$
Storage temperature	T_{stg}	-40 to +100	$^\circ\text{C}$

Optical and Electrical Characteristics ($T_C = 25^\circ\text{C}$)

Item		Symbol	Min	Typ	Max	Unit	Test Conditions
Optical output power	HE8807SG	P_O	10	20	—	mW	$I_F = 150\text{ mA}$
	HE8807FL	P_f^*	0.5	1.0	—		$I_F = 20\text{ mA}$
Peak wavelength		λ_p	800	880	900	nm	$I_F = 150\text{ mA}$
Spectral width		$\Delta\lambda$	—	30	—	nm	$I_F = 150\text{ mA}$
Forward voltage		V_F	—	1.7	2.3	V	$I_F = 150\text{ mA}$
Reverse current		I_R	—	—	100	μA	$V_R = 3\text{ V}$
Capacitance		C_t	—	10	—	pF	$V_R = 0\text{ V}$, $f = 1\text{ MHz}$
Rise time		t_r	—	20	—	ns	$I_F = 50\text{ mA}$
Fall time		t_f	—	20	—	ns	$I_F = 50\text{ mA}$

Note: P_f specification: The optical output within 9 degrees of the acceptance angle.

Typical Characteristic Curves

Optical Output Power vs. Forward Current
(HE8807SG)

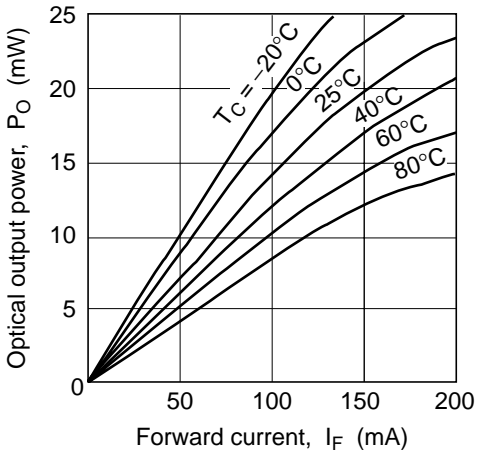

Forward Current vs. Forward Voltage

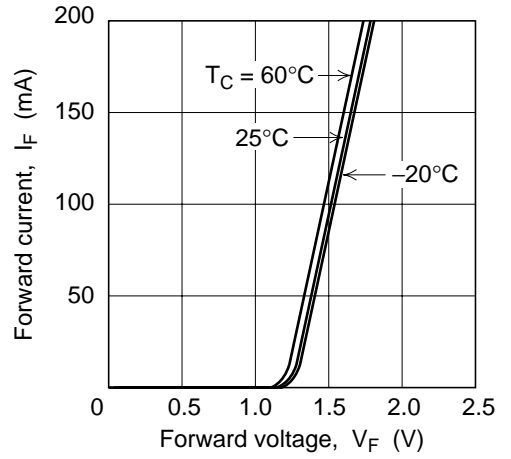

Wavelength Distribution

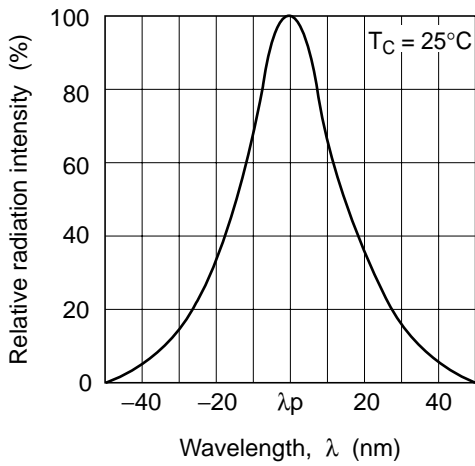

Pulse Response

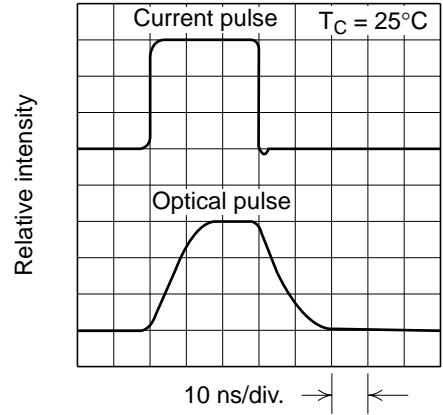

Typical Characteristic Curves (cont)

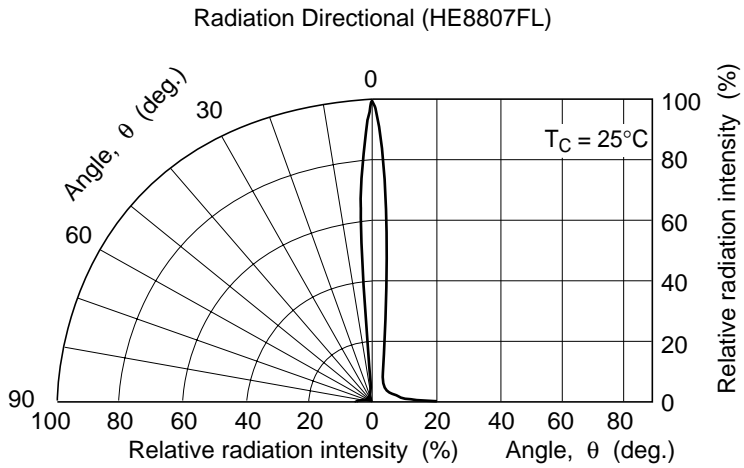
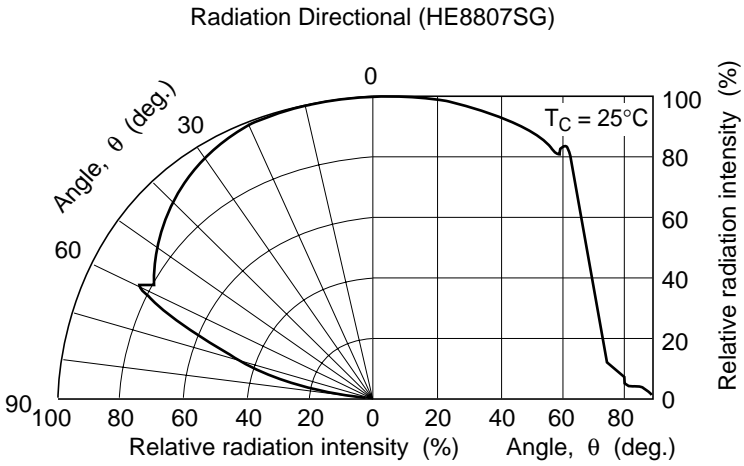

Typical Characteristic Curves (cont)

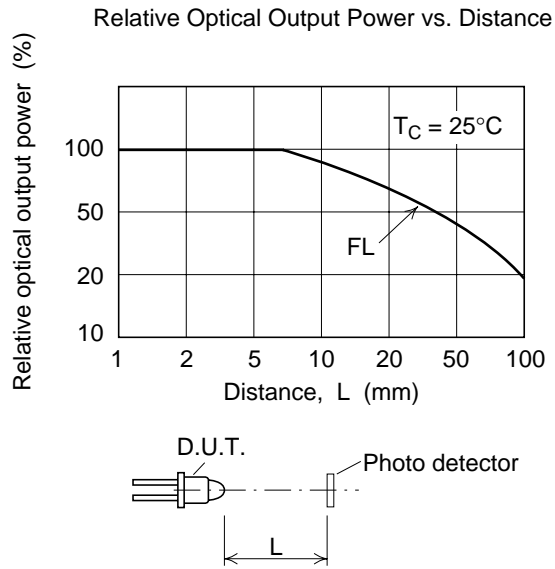

Unit: mm

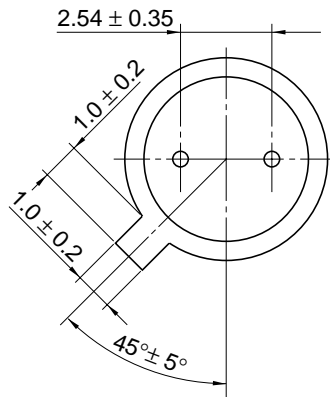
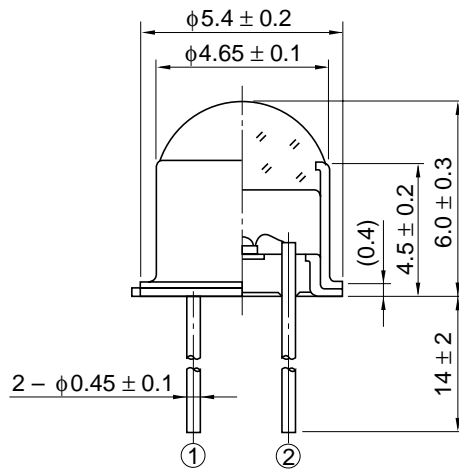
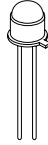

Hitachi Code	IR/FL
JEDEC	—
EIAJ	—
Mass (reference value)	0.27 g

Cautions

1. Hitachi neither warrants nor grants licenses of any rights of Hitachi's or any third party's patent, copyright, trademark, or other intellectual property rights for information contained in this document. Hitachi bears no responsibility for problems that may arise with third party's rights, including intellectual property rights, in connection with use of the information contained in this document.
2. Products and product specifications may be subject to change without notice. Confirm that you have received the latest product standards or specifications before final design, purchase or use.
3. Hitachi makes every attempt to ensure that its products are of high quality and reliability. However, contact Hitachi's sales office before using the product in an application that demands especially high quality and reliability or where its failure or malfunction may directly threaten human life or cause risk of bodily injury, such as aerospace, aeronautics, nuclear power, combustion control, transportation, traffic, safety equipment or medical equipment for life support.
4. Design your application so that the product is used within the ranges guaranteed by Hitachi particularly for maximum rating, operating supply voltage range, heat radiation characteristics, installation conditions and other characteristics. Hitachi bears no responsibility for failure or damage when used beyond the guaranteed ranges. Even within the guaranteed ranges, consider normally foreseeable failure rates or failure modes in semiconductor devices and employ systemic measures such as fail-safes, so that the equipment incorporating Hitachi product does not cause bodily injury, fire or other consequential damage due to operation of the Hitachi product.
5. This product is not designed to be radiation resistant.
6. No one is permitted to reproduce or duplicate, in any form, the whole or part of this document without written approval from Hitachi.
7. Contact Hitachi's sales office for any questions regarding this document or Hitachi semiconductor products.

1. The laser light is harmful to human body especially to eye no matter what directly or indirectly. The laser beam shall be observed or adjusted through infrared camera or equivalent.

HITACHI

Hitachi, Ltd.

Semiconductor & Integrated Circuits.

Nippon Bldg., 2-6-2, Ohte-machi, Chiyoda-ku, Tokyo 100-0004, Japan

Tel: Tokyo (03) 3270-2111 Fax: (03) 3270-5109

URL NorthAmerica : <http://semiconductor.hitachi.com/>
 Europe : <http://www.hitachi-eu.com/hel/ecg>
 Asia : <http://sicapac.hitachi-asia.com>
 Japan : <http://www.hitachi.co.jp/Sicd/indx.htm>

For further information write to:

Hitachi Semiconductor
(America) Inc.
179 East Tasman Drive,
San Jose, CA 95134
Tel: <1> (408) 433-1990
Fax: <1> (408) 433-0223

Hitachi Europe GmbH
Electronic Components Group
Dornacher Straße 3
D-85622 Feldkirchen, Munich
Germany
Tel: <49> (89) 9 9180-0
Fax: <49> (89) 9 29 30 00

Hitachi Europe Ltd.
Electronic Components Group.
Whitebrook Park
Lower Cookham Road
Maidenhead
Berkshire SL6 8YA, United Kingdom
Tel: <44> (1628) 585000
Fax: <44> (1628) 585160

Hitachi Asia Ltd.
Hitachi Tower
16 Collyer Quay #20-00,
Singapore 049318
Tel : <65>-538-6533/538-8577
Fax : <65>-538-6933/538-3877
URL : <http://www.hitachi.com.sg>

Hitachi Asia Ltd.
(Taipei Branch Office)
4/F, No. 167, Tun Hwa North Road,
Hung-Kuo Building,
Taipei (105), Taiwan
Tel : <886>-(2)-2718-3666
Fax : <886>-(2)-2718-8180
Telex : 23222 HAS-TP
URL : <http://www.hitachi.com.tw>

Hitachi Asia (Hong Kong) Ltd.
Group III (Electronic Components)
7/F., North Tower,
World Finance Centre,
Harbour City, Canton Road
Tsim Sha Tsui, Kowloon,
Hong Kong
Tel : <852>-(2)-735-9218
Fax : <852>-(2)-730-0281
URL : <http://www.hitachi.com.hk>

Copyright © Hitachi, Ltd., 2000. All rights reserved. Printed in Japan.
Colophon 2.0

HITACHI