

Insulator color: Purple (Pantone 2715C)  
(See PC99 spec)

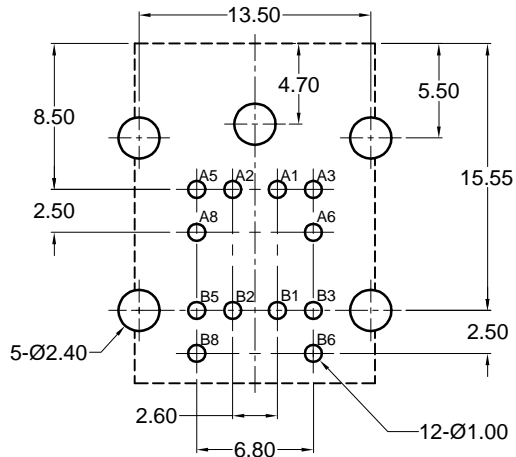
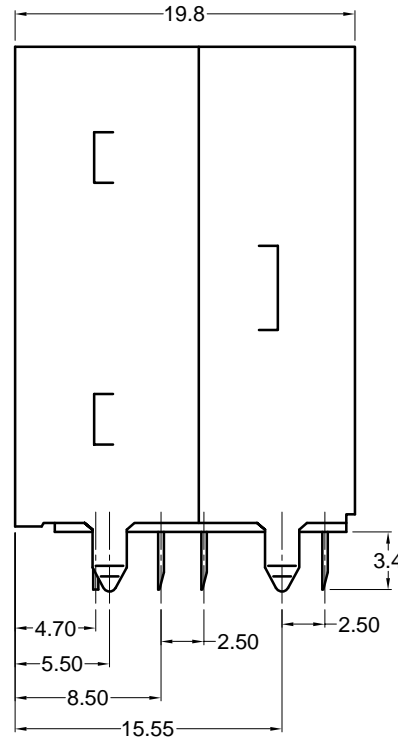
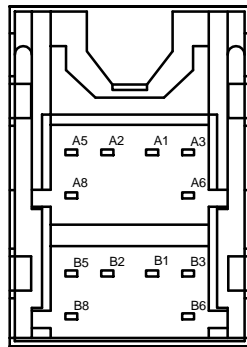

Recommended PCB Layout  
(Bottom View)

**Material and Finish**

Body: PBT Thermoplastic,  
UL94V-0 Rated

Color:

Upper Socket: Pantone 3395C, Green  
Lower Socket: Pantone 2715C, Purple  
(To meet PC99 Spec)

Contacts: Phosphor Bronze  
Gold Flash on Contacts,  
Tin/Lead on Termination

Shield: Brass, Tin plated

**Electrical Characteristics**

Contact Resistance:

Before Test:  
Plug to Terminals: 30 Milliohms Max.

After Test:  
Plug to Terminals: 60 Milliohms Max.

Insulation Resistance:  
500 Megohms Min.

Dielectric Withstanding Voltage:  
500V AC RMS For 1 Minute

Current Rating:  
2 Amp at 12V DC

**Mechanical Characteristics**

Durability Test: 500 Cycles Min.

Insertion Force: 4.5kg max.

Extraction Force: 0.4kg - 3.5kg

Operating Temperature: -25°C to +85°C

Tolerances

X.X ± 0.35  
X.XX ± 0.25  
Unless Stated  
Otherwise



REVISION	DATE	DESCRIPTION	DRAWN BY	CHECKED BY	UNITS
A1	1/28/00	New Drawing	M. Ylu	K. Wallace	mm
A2	4/19/01	Ref ECO 01-073	REVISED BY	REV CHECK BY	DATE
A3	5/22/03	Ref ECO 02-062	C. Leiva	T. Gokcek	1/28/00

KMDG-6SG/P-S4N1

Stacked Mini-Din, 6/6, PC99

Fully Shielded, Gold Contacts, w/Mounting Hole

