

SURFACE MOUNT ATTENUATORS

PART #	ATTENUATION (dB)	TOL. (+/-dB)	WIDTH	LENGTH	THK	POWER (WATTS)	VSWR	FREQ. (GHz)
RFP-250250-4AA1	1	0.20	0.25	0.25	0.04	8	1.20:1	2
RFP-250250-4AA2	2	0.30	0.25	0.25	0.04	8	1.20:1	2
RFP-250250-4AA3	3	0.30	0.25	0.25	0.04	8	1.20:1	2
RFP-250250-4AA4	4	0.30	0.25	0.25	0.04	8	1.20:1	2
RFP-250250-4AA5	5	0.30	0.25	0.25	0.04	8	1.20:1	2
RFP-250250-4AA6	6	0.40	0.25	0.25	0.04	8	1.20:1	2
RFP-250250-4AA9	9	0.60	0.25	0.25	0.04	8	1.20:1	2
RFP-250250-4AA10	10	0.70	0.25	0.25	0.04	8	1.20:1	2
RFP-250250-4AA20	20	0.75	0.25	0.25	0.04	8	1.20:1	2
RFP-250250-4AA30	30	0.75	0.25	0.25	0.04	8	1.20:1	2

CHIP ATTENUATORS

PART #	ATTENUATION (dB)	TOL. (+/-dB)	WIDTH	LENGTH	THK	POWER (WATTS)	VSWR	FREQ. (GHz)
RFP-40-XXCAP	1-6	0.2	0.250	0.250	0.04	40	1.15:1	2
RFP-40-9CAP	9	0.3	0.250	0.250	0.04	40	1.15:1	2
RFP-40-10CAP	10	0.4	0.250	0.250	0.04	40	1.15:1	2
RFP-40-20CAP	20	0.5	0.250	0.250	0.04	40	1.20:1	2
RFP-40-30CAP	30	1.0	0.250	0.250	0.04	40	1.20:1	2
RFP-40-XXCAPZ	1-6	0.2	0.250	0.250	0.04	40	1.15:1	2
RFP-40-9CAPZ	9	0.3	0.250	0.250	0.04	40	1.15:1	2
RFP-40-10CAPZ	10	0.4	0.250	0.250	0.04	40	1.15:1	2
RFP-40-20CAPZ	20	0.5	0.250	0.250	0.04	40	1.20:1	2
RFP-40-30CAPZ	30	1.0	0.250	0.250	0.04	40	1.20:1	2
RFP-50-XXCAF	1-5	0.2	0.225	0.350	0.04	50	1.25:1	2
RFP-50-6CAF	6	0.3	0.225	0.350	0.04	50	1.20:1	2
RFP-50-9CAF	9	0.4	0.225	0.350	0.04	50	1.20:1	2
RFP-50-10CAF	10	0.4	0.225	0.350	0.04	50	1.20:1	2
RFP-50-20CAF	20	0.5	0.225	0.350	0.04	50	1.20:1	2
RFP-50-30CAF	30	1.0	0.225	0.350	0.04	50	1.20:1	2
RFP-50-XXCAMZ	1-6	0.3	0.375	0.375	0.04	50	1.25:1	2
RFP-50-9CAMZ	9	0.3	0.375	0.375	0.04	50	1.25:1	2
RFP-50-10CAMZ	10	0.3	0.375	0.375	0.04	50	1.25:1	2
RFP-50-20CAMZ	20	0.5	0.375	0.375	0.04	50	1.25:1	2
RFP-50-30CAMZ	30	1.0	0.375	0.375	0.04	50	1.25:1	2

General Notes:

- 1) Tolerance is +/- .010 unless otherwise specified.
- 2) Operating temperature: -55°C to +150°C.

3) Terminals: Platinum silver.

4) Substrate: Thick film printing on Beryllium Oxide ceramic.

5) Non-NiCr design note.

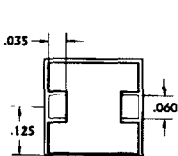

RFP-40-XXCAP
(TOP CONDUCTOR)

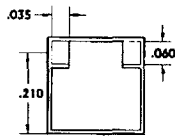

RFP-40-XXCAPZ
(TOP CONDUCTOR)

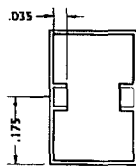

RFP-50-XXCAF
(TOP CONDUCTOR)

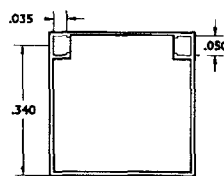

RFP-50-XXCAMZ
(TOP CONDUCTOR)

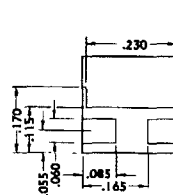

RFP-250250-4AA(1-10)-2
(BACK CONDUCTOR)

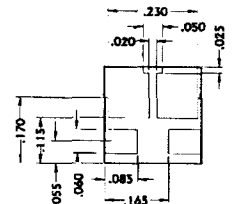

RFP-250250-4AA(20/30)-2
(BACK CONDUCTOR)

RF Power

Components, Inc.

The Proven Standard in Quality

125 Wilbur Place • Bohemia, NY 11716 U.S.A. • TEL: 516-563-5050 • FAX: 516-563-4747 • www.rf-power.com

Call toll free 877-RFPC-INC (877-737-2462) for nearest representative.