

SMT Power Inductor (MOLDING TYPE)

MPO10X Type

Features

- RoHS compliant.
- Low profile, high current SMD type.
- Frequency range up to 1MHz.
- Lowest DCR/ μH , in this package size.
- Low buzz noise due to its gap-less structure.

Applications

- Notebook/Desktop/Server/Video Card applications.
- High current POL converters.
- Low profile, high current power supplies.
- Battery powered devices.
- Ideal for power source circuits, DC-DC converter.
- DC-AC inverters inductor application.

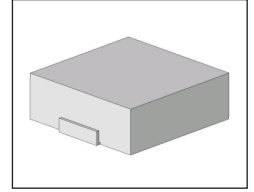

Mechanical Dimension:

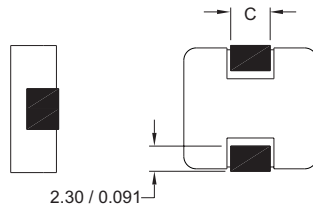
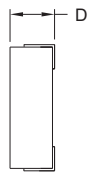
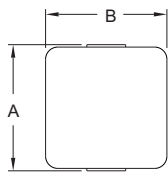

RECOMMENDED PAD PATTERNS

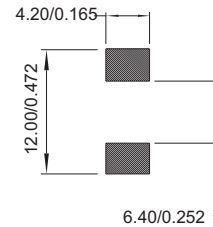

UNIT : mm/inch
 A = 11.50 / 0.453 Max.
 B = 10.00 \pm 0.30 / 0.394 \pm 0.012

Electrical Characteristics: At 25°C: 100KHz, 0.25V

PART NO.	L0 (μH)	DCR ($\text{m}\Omega$) TYP.	DCR ($\text{m}\Omega$) MAX.	Isat ¹ (A dc)	I _r ² (A dc)	Dimension "C" mm / inch $\pm 0.5 / \pm 0.02$	Dimension "D" mm / inch MAX
MPO1035-R68	0.68 \pm 20%	2.30	2.80	38	25	2.3 / 0.091	3.5 / 0.138
MPO1035-1R0	1.00 \pm 20%	3.35	3.80	26	21	2.0 / 0.079	3.5 / 0.138
MPO104-R36	0.36 \pm 20%	1.08	1.20	45	30	3.5 / 0.138	4.0 / 0.157
MPO104-R39	0.39 \pm 20%	1.08	1.20	35	30	3.5 / 0.138	4.0 / 0.157
MPO104-R45-C	0.45 \pm 20%	1.25	1.45	35	30	3.5 / 0.138	4.0 / 0.157
MPO104-R56	0.56 \pm 20%	1.60	1.80	36	25	3.0 / 0.118	4.0 / 0.157
MPO104-0R9	0.90 \pm 20%	2.45	2.65	27	25	3.0 / 0.118	4.0 / 0.157
MPO104-1R0	1.00 \pm 20%	2.80	3.00	30	21	2.6 / 0.103	4.0 / 0.157
MPO104-1R5	1.50 \pm 20%	3.80	4.20	33	20	2.3 / 0.091	4.0 / 0.157

1. Isat is the DC current which cause the inductance drop approximately 20% of its nominal inductance without current.
2. I_r is the DC current which cause the surface temperature of the part increase approximately 40°C
3. Operating temperature range : -55°C to 125°C
4. Ambient temperature, Maximum : 85°C.



DELTA ELECTRONICS, INC.

(TAOYUAN PLANT CPBG) 252, SAN YING ROAD, KUEISAN INDUSTRIAL ZONE, TAOYUAN SHIEN, 333, TAIWAN, R.O.C.

TEL: 886-3-3591968; FAX: 886-3-3591991

<http://www.deltaww.com>