

1. CONFIGURATION & DIMENSIONS :

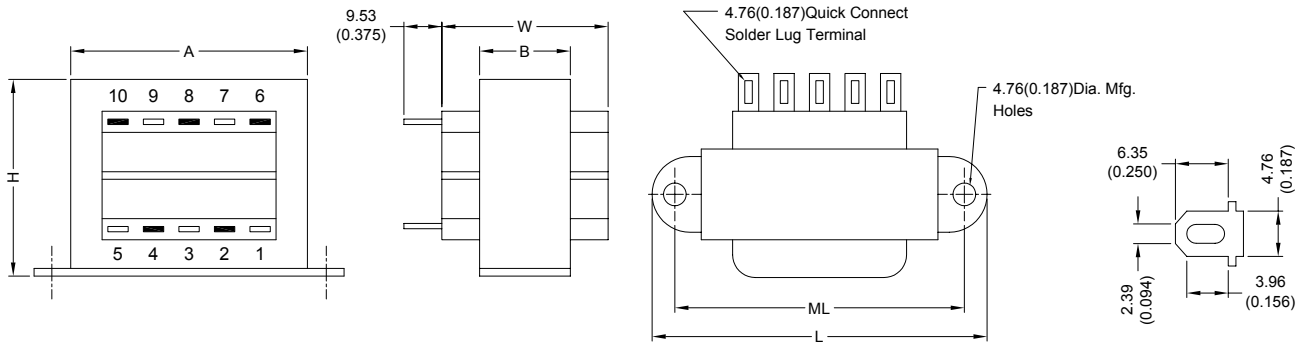

UNIT : mm (inch)

| SIZE | VA | L | W | H | A | B | ML | gram |
|------|----|------------------|------------------|------------------|------------------|------------------|------------------|--------|
| 7 | 56 | 93.68 (3.688) | 46.05 (1.813) | 57.15 (2.250) | 68.28 (2.688) | 27.00 (1.063) | 79.38 (3.125) | 771.11 |

2. SCHEMATIC :

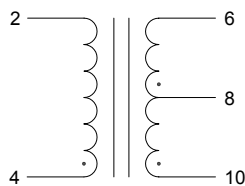

" . " indicates polarity

3. ELECTRICAL CHARACTERISTICS (@ 25°C) :

| | |
|--------------------------------------|------------------------------------|
| a. Primary Voltage | AC 115 V 60 Hz . |
| b. No Load Primary Current | Less Than 80mA . |
| c. Secondary Voltage (±5%) | |
| Pin 6-10 C.T. Pin 8 | AC 40.4 V . |
| d. Secondary Load Current | 1.50A . |
| e. Full Load Primary Current | Less Than 620mA . |
| f. Full Load Secondary Voltage (±5%) | 36.00V . |
| Pin 6-10 C.T. Pin 8 | |
| g. DC Resistance | |
| Pin 2-4 | Primary = 10.50 Ohm . |
| Pin 6-8 | Secondary-1 = 0.62 Ohm . |
| Pin 8-10 | Secondary-2 = 0.71 Ohm . |
| h. Insulation Resistance | DC 500V 100Meg Ohm Of More . |
| i. Withstand Voltage (Hi-Pot) | AC 2500V 60Hz 1 Minutes . |
| j. Temperature Rise | Less Than 60 Deg C . |
| k. Core Size | EI-66 x 26.00 m/m . |
| l. Turns & Wire Gauge | |
| Primary Pin 2-4 | 585 Turns Diameter : 0.40 mm |
| Secondary Pin 6-8-10 | 0-103-206 Turns Diameter : 0.65 mm |



RoHS Compliant

NOTE : Specifications subject to change without notice. Please check our website for latest information.

25.02.2008



SUPERWORLD ELECTRONICS (S) PTE LTD