

ML-1K3

The ML-1K3 is a high-power GaAlAs IRED mounted in durable, hermetically sealed TO-18 metal can package, providing years of reliable performance even under demanding conditions such as use outdoors.

FEATURES

- Durable
- High reliability in demanding environments

APPLICATIONS

- Transportation sensors
- Infrared sensors
- Optical switches

MAXIMUM RATINGS

(Ta=25°C)

Parameter	Symbol	Rating	Unit
Reverse Voltage	V _R	3	V
Forward Current	I _F	50	mA
Pulse Forward Current (see Note 1)	I _{FP}	0.5	mA
Power Dissipation	P _D	85	mW
Operating Temperature	Topr.	-30~+100	°C
Storage Temperature	Tstg.	-40~+100	°C
Soldering temperature *1	Tsol.	240	°C

Notes : *1. For MAX.5 seconds at the position of 2mm from the package

DIMENSION

(Unit : mm)

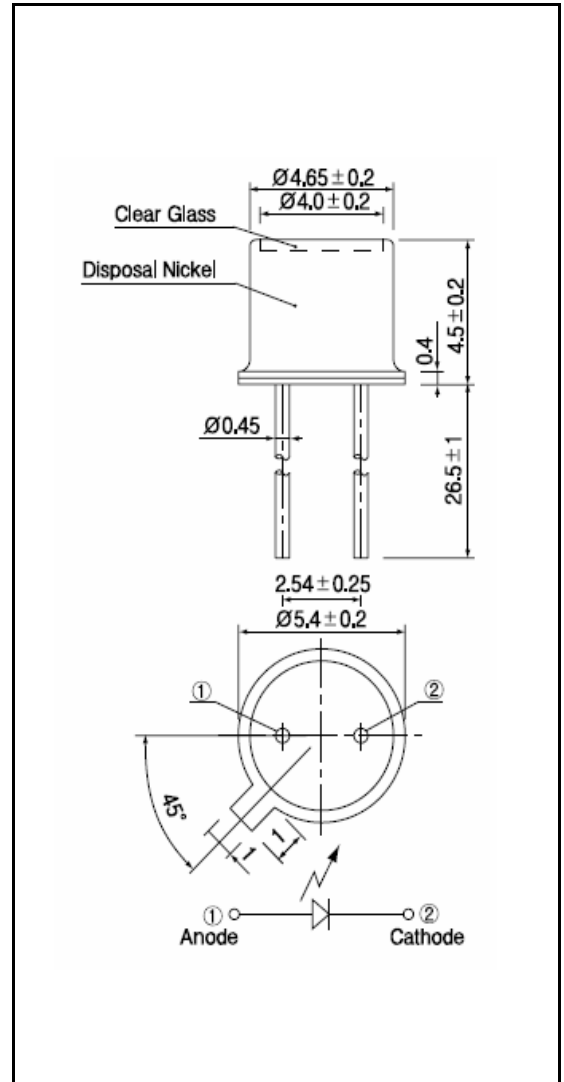

ELECTRO-OPTICAL CHARACTERISTICS

(Ta=25°C, unless otherwise noted)

Parameter	Symbol	Conditions	Min	Typ	Max	Unit
Forward Voltage	V _F	I _F = 50 mA		1.4	1.7	V
Reverse Current	I _R	V _R = 3V			10	uA
Peak Emission Wavelength	λ_p	I _F = 50mA	-	865	-	nm
Spectral Bandwidth	$\Delta\lambda$	I _F = 50mA	-	30	-	nm
Radiant Intensity	P _o	I _F = 50mA	40			mV
Half Angle	$\Delta\theta$			± 36		deg.

Notes : *2. Irradiance by CIE standard light source A (2850K tungsten lamp)

ML-1K3

power dissipation Vs. Ambient Temperature

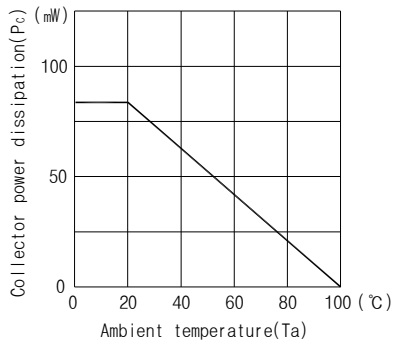

Radiant intensity Vs. Forward current

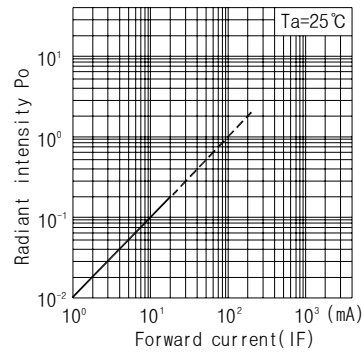

Radiant intensity Vs. Ambient temperature

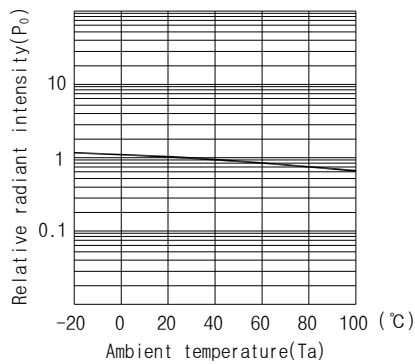

Relative Sensitivity Vs. Wavelength

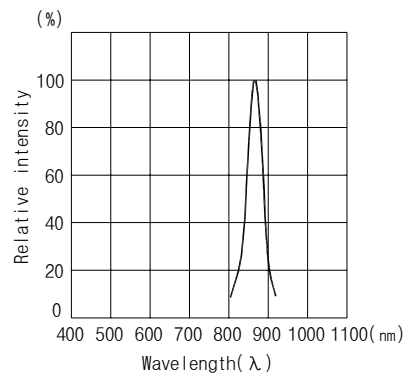

Forward current Vs. Forward voltage

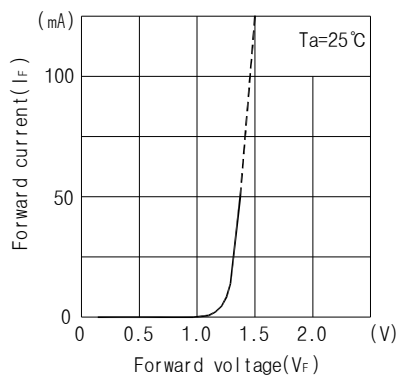

Radiant Pattern

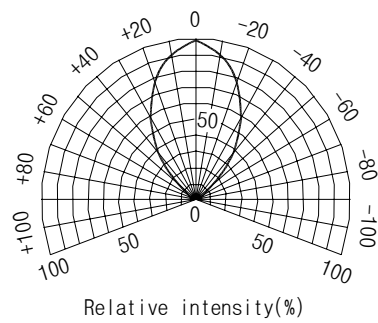

Radiant intensity Vs. Distance

