

SK7429

POSITRONIC INDUSTRIES BELIEVES THE DATA ON THIS DRAWING TO BE RELIABLE. SINCE THE TECHNICAL INFORMATION IS GIVEN FREE OF CHARGE, THE USER EMPLOYS SUCH INFORMATION AT HIS OWN DISCRETION AND RISK. POSITRONIC INDUSTRIES ASSUMES NO RESPONSIBILITY FOR RESULTS OBTAINED OR DAMAGES INCURRED FROM USE OF SUCH INFORMATION IN WHOLE OR IN PART.

DATE	REV	REVISION RECORD	APP	DR	CK
5-16-06	NC	ECO 25970	TK	COLE	COLE
8-6-07	A	ECO 28275	RCW	YK	COLE

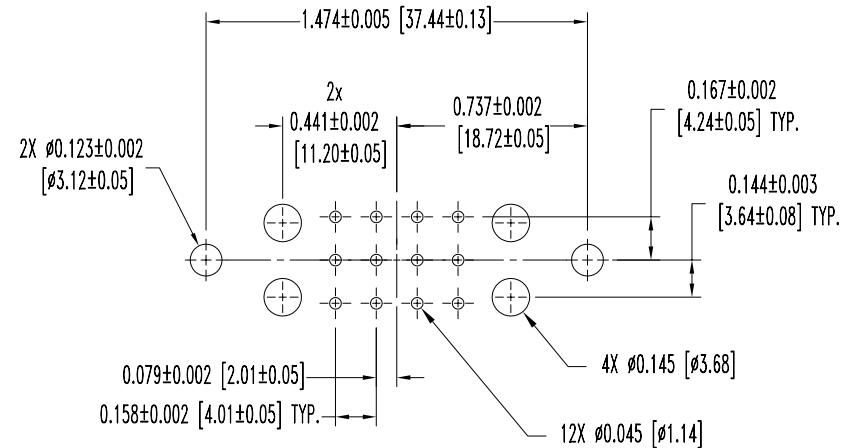
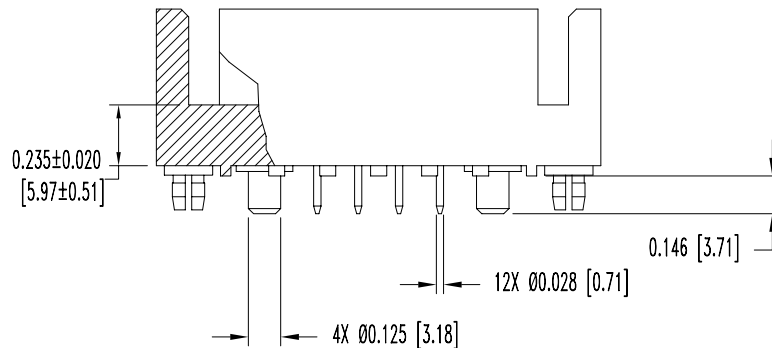
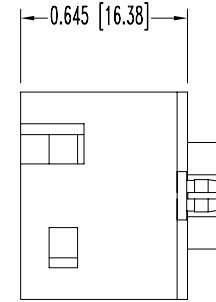
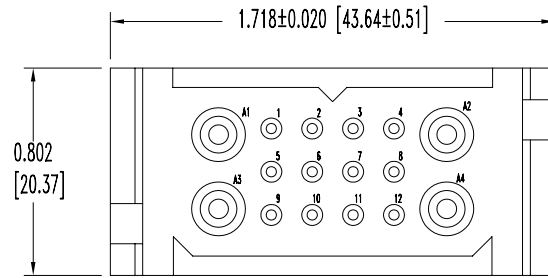

CONTACT HOLE PATTERN

NOTES:

- MATERIALS AND FINISHES:
 INSULATOR: GLASS FILLED POLYESTER, UL 94V-0, COLOR BLUE.
 CONTACTS: PRECISION MACHINED COPPER ALLOY, GOLD FLASH OVER NICKEL.
 PUSH-ON FASTENER: SPRING TEMPERED COPPER ALLOY, TIN PLATE.
- ELECTRICAL CHARACTERISTICS:
 CONTACT CURRENT RATING - POWER: 75 AMPS. SIGNAL: 7.5 AMPS PER UL 1977.
 INITIAL CONTACT RESISTANCE - POWER: 0.0005 OHMS MAX. SIGNAL: 0.008 OHMS MAX. PER IEC 512-2, TEST 2b.
 INSULATION RESISTANCE: 5 G OHMS PER IEC 512-2, TEST 3a, METHOD A.
 WORKING VOLTAGE: 300 VAC.
- WORKING TEMPERATURE: -55°C TO +125°C.
- DIMENSIONS ARE IN INCHES [MILLIMETERS].

	POSITRONIC INDUSTRIES INC. www.connectpositronic.com		FSCM 28198
	PCS SERIES	SCALE N.T.S.	DRAWN BY COLE
DECIMAL TOL. ± 0.015 [0.38]	TITLE PLC16W4M3N0A1		
ANGULAR TOL. ± 5°	DATE 5-16-06	DRAWING NUMBER SK7429	REV. A
		APPROVED BY T.KEPLEY	