

SPECIFICATIONS

1. ELECTRICAL CHARACTERISTICS:

- 1-1 MATED LOOP INDUCTANCE (MEASUREMENT FREQUENCY FOR PIN-TO-PIN/CONNECTOR-TO-CONNECTOR INDUCTANCE: 1 GHz): 3.0 nH MAX
- 1-2 MUTUAL CAPACITANCE (MEASUREMENT FREQUENCY FOR PIN-TO-PIN/CONNECTOR-TO-CONNECTOR CAPACITANCE: 400 MHz): 0.5 pF MAX
- 1-3 FINAL MATED CONNECTION RESISTANCE (AVERAGE OF MINIMUM 40 PIN/CONNECTOR MATED CONNECTIONS): 25 m Ω MAX
- 1-4 INSULATION RESISTANCE : 800 m Ω MIN
- 1-5 DIELECTRIC WITHSTAND VOLTAGE: 360 V RMS MIN
- 1-6 CURRENT-MAX (AMPS): 0.5A
- 1-7 VOLTAGE-MAX(VOLTS): 100V

2. MECHANICAL CHARACTERISTICS:

- 2-1 SOCKET ENGAGEMENT/DISENGAGEMENT FORCE: TORQUE 5.0 kg-cm (0.49 NT-m) MAX
- 2-2 SOCKET RETENTION FORCE: 10 g/pin MIN
- 2-3 DURABILITY (MATING CYCLES): 20 cycles MIN

3. ENVIRONMENT PERFORMANCE:

- 3-1 TEMPERATURE CYCLE (-550C~1250C): 500 cycles MIN
- 3-2 BIASED HAST (130°C, 85%RH): 100 hours MIN
- 3-3 BAKE (125°C): 1000 hours MIN
- 3-4 MECHANICAL SHOCK: TRAPEZOIDAL 50 g, 11 ms PULSE, VELOCITY CHANGE 170 in/sec
- 3-5 VIBRATION: 5 Hz - 20 Hz 0.01 g²/Hz SLOPING UP TO 0.02 g²/Hz, 20 Hz - 500 Hz 0.02 g²/Hz, 3.13 g RMS RANDOM

4. STORAGE CONDITION:

- 4-1. TEMPERATURE RANGE: -20 ° C to +90 ° C
- REMARK: HARMFUL MATERIAL CONTROL PLEASE FOLLOW DOC: EPI 12.

BGA 479 SOCKET

BGA Series projector Socket Type

**1.27 mm [0.05"] Pitch
479 Pos.**



DRAWING

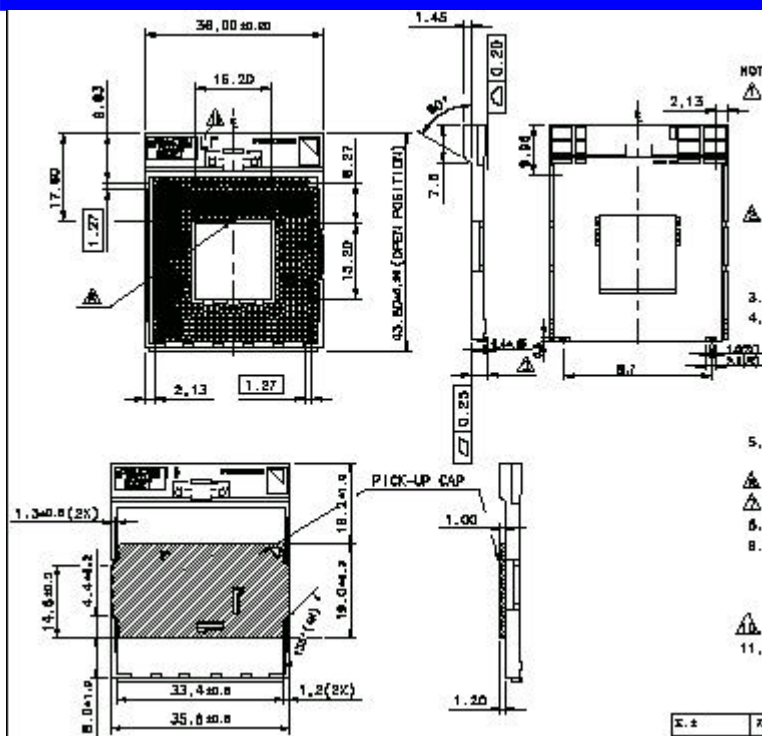

ORDERING INFORMATION

