

1 2 3 4 5 6 7 8

### TECHNICAL DATA

#### D-SUBMINIATURE CONNECTORS

**SHELL** : Steel  
**Finish** : Tinned  
**BODY** : Glass filled thermoplastic.  
 Flame retardant to UL94 V-0  
**Color** : Black  
**CONTACTS** : Material for Copper Alloy  
 Finish of contact mating area:  
 Gold plating over Nickel  
**ELECTRICAL** : Voltage rating 300 V Rms to 50 Hz  
 150 V Rms to 50 Hz(Shielded contacts)  
 Nominal current 7.5 A (Size 20)  
 Withstanding Voltage >1000 V Rms to 50 Hz  
 Contact resistance 50 mOhms max.  
 Insulator resistance >5000 M Ohms  
**CLIMATIC** : Temperature range -55 degree up to 155 degree  
 Damp heat 56 days(40 degree-95% HR)  
 Other climatic specification in accordance with  
 NF C93-425 Sheet HE507  
**MACHANICAL** : Insertion force per contact 1.2N <F<2.5N(Size 20)  
 Extraction force per contact 0.4N MINI.(Size 20)  
 Mating and unmating force size B 83N Max.8.0 N mini.  
**MARKING** : Amphenol...(Series No.)  
 Commercial reference  
 Manufacturing date

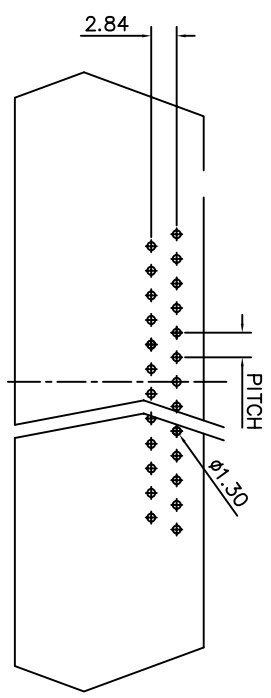
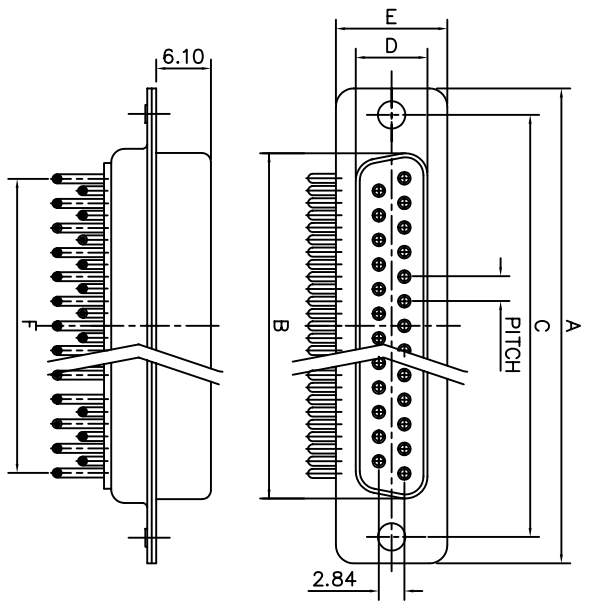
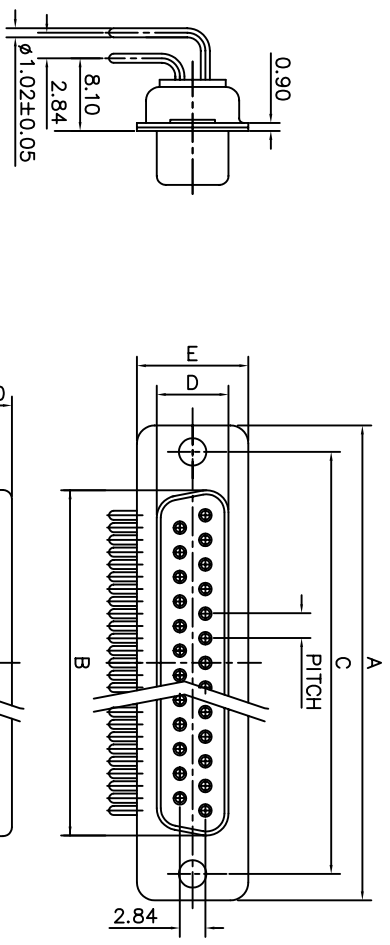

RECOMMENDED P.C.B LAYOUT

ONS/SHELL	A +0.25 -0.25	B +0.00 -0.20	C +0.10 -0.10	D +0.00 -0.25	E +0.20 -0.20	PITCH	F	POS.
E	30.70	16.40	25.00	8.00	12.40	2.74	10.96	9
A	39.00	24.80	33.30	8.00	12.40	2.74	19.18	15
B	52.90	38.50	47.00	8.00	12.40	2.76	33.12	25
C	69.20	54.90	63.50	8.00	12.40	2.76	49.68	37

#### PRODUCT CODE

L77D A 15 S C

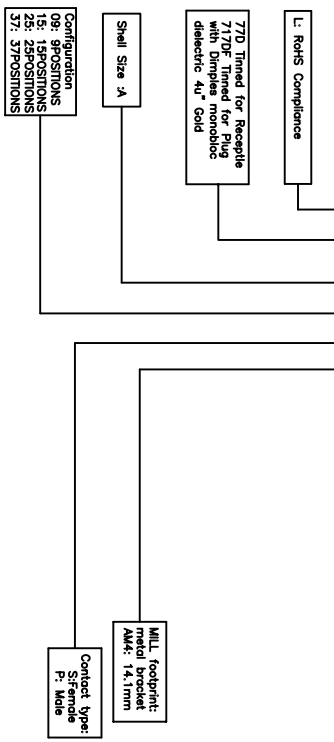

## Amphenol Socapex

SERIES		TOL. GEN. : +/0.30	
NUMBER SERIES		VOLUME:	
D/DF		AREA:	
FILE:		PLATING:	
DESIGNATION		TREATMENT:	
D-SUB CONNECTOR		MATERIAL:	
DATE	2006.04.25	CUSTOMER	origin drawing
COMMERCIAL PART NUMBER		MODIFICATIONS	Li.k
L77DAXXSC		DRAW DATE	04/25/06
		APPROVE	Li.k
		IND	A