

ASSEMBLY - VIEW FROM FRONT

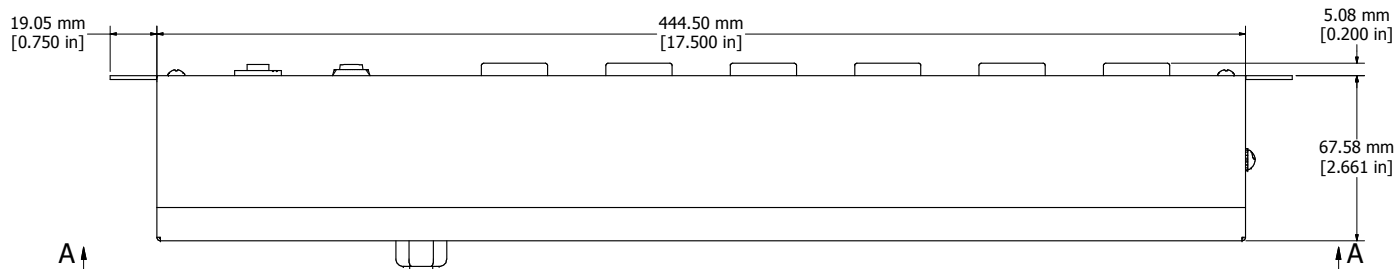

6' FOOT TWIST POWER CORD (NEMA L5-15P)

ASSEMBLY - VIEW FROM BOTTOM

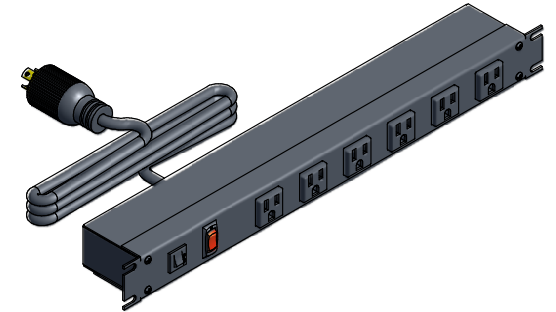
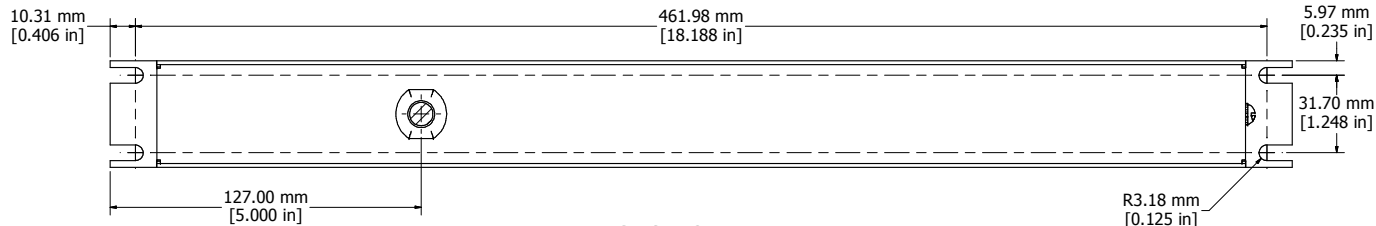

ISOMETRIC VIEW

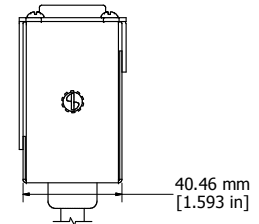

ASSEMBLY - VIEW FROM SIDE

1582H6C1BKRA

Finish - Front - Black Painted Steel

Back - Black Painted Steel

Rated - 125 VAC, 60 Hz, 15 Amps

Approvals - CSA Certified Standards C22.2 (No. 21-95, 42-99)

- UL Recognized Standard UL1363

Cord Length

1582H6C1BKRA - 6' Foot Twist Power Cord (NEMA L5-15P)

1582H6D1BKRA - 15' Foot Twist Power Cord (NEMA L5-15P)



HAMMOND MANUFACTURING™

1582H6C1BKRA

www.hammondmfg.com