

Rev	AWO #	Description	Date	Appr
-	8366	RELEASED	1/18/08	

APPROVED: _____
 DATE: _____ TITLE: _____

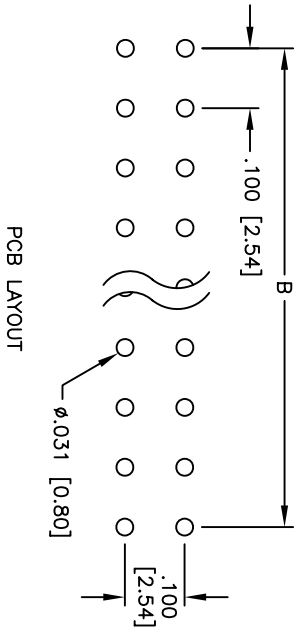
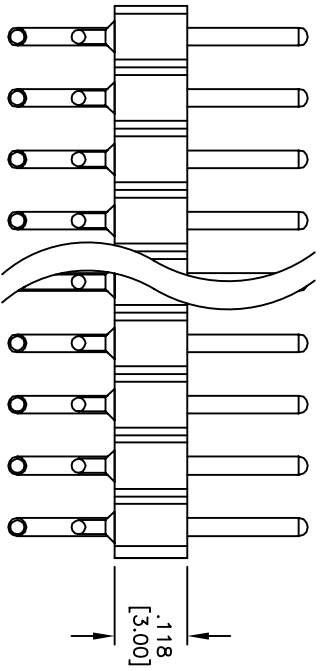
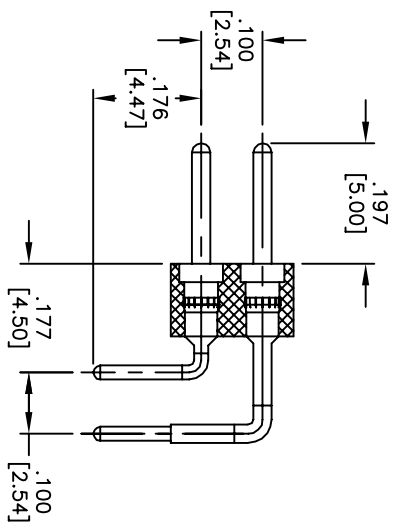
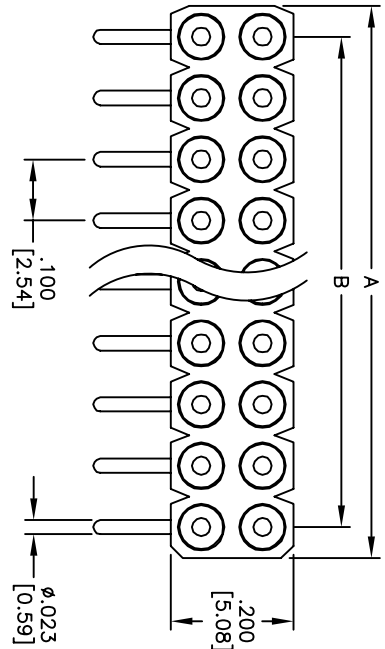

SPECIFICATIONS:
 Material: Insulator: Valox, Glass reinforced, rated UL 94V-0
 Insulator color: Black
 Contacts: Brass
 Plating: Gold over Nickel underplate overall

Electrical:
 Operating voltage: 250 VAC max
 Current rating: 3 Amp max
 Contact resistance: 30 mohms max initial
 Insulation resistance: 1,000 Mohms min
 Dielectric withstanding voltage: 500 VAC for 1 minute
 Temperature Rating:
 Operating temperature: -55°C to +125°C
 Environmental:
 Lead free, RoHS compliant
 Recommended soldering temp: 260°C for 5 seconds

Positions: 2 thru 80
 A = .100 [2.54] x No. of Positions per Row
 B = .100 [2.54] x No. of Spaces per Row

UNLESS OTHERWISE SPECIFIED
 ALL DIMENSIONS ARE IN INCHES [MM]
 TOLERANCES: EXCEPT AS NOTED

INCHES	HOLES
.X ± .10	ØX ± .10
.XX ± .020	ØXX ± .015
.XXX ± .015	ØXXX ± .010

APPROVALS: _____ DATE: _____

DRAWN	SS	1/18/08
CHECKED		
APPROVED		

ADAM TECH
 909 Rahway Avenue, Union, NJ 07083
 Phone: 908-687-5000 Fax: 908-687-5710

TITLE: SCREW MACHINE TERMINAL STRIP, DUAL ROW
 RIGHT ANGLE, .100" X .100" SPACING, GOLD

SIZE	PART NO.	REV.
X	MCT-2R-XX-1-G	-
REF:	SCALE: NTS	SHEET 1 OF 1

