

euro-block

product specification

Electrical

Standard:	UL	IEC
Rated voltage:	300V	400V
Rated current:	7A	5A
Wire range:	26-16AWG	1.5mm ²
Withstanding voltage:	AC2000V/1Min	
Insulation resistance:	500M Ω /DC1000V	

Mechanical

Temp.Range:	-40° C~+105° C
MAX Soldering:	+250° C, for 5 Sec
Strip length:	8-9mm

Dimensions

Pitch:	3.5mm
Poles:	1P-XXP

Material

Housing:	PA66, UL94V-0
Pin header:	Phosphor bronze, Tin plated

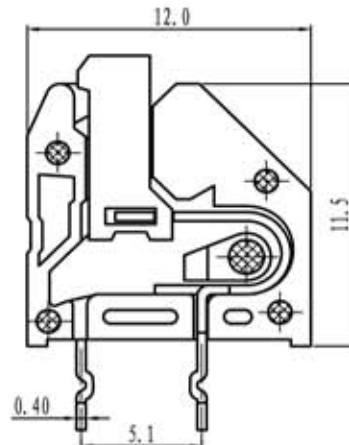
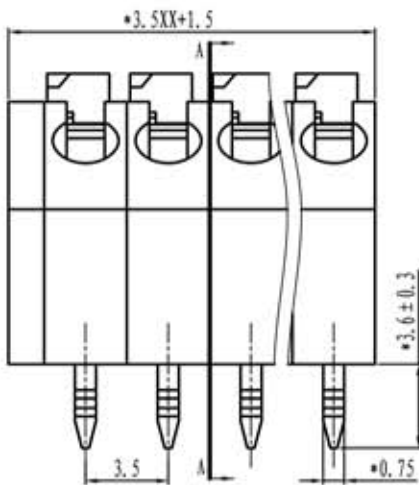

SECTION A-A

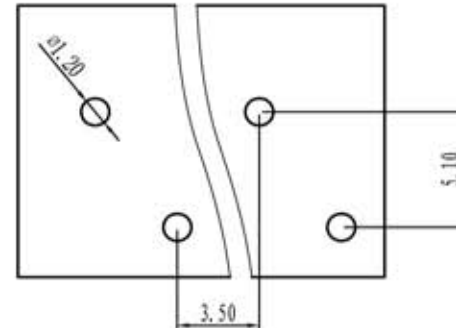

Versione/Version

Date

2013-2

18/03/2013

TOLERANCES EXCEPT AS NOTED

Schema generale del codice di ordinazione/General description of ordering code

Series	n. poles	pitch	version	color	custom
MRM1	2-24	3.50			

variable range	linear dimension					fillet	chamfer	short angle sid				≡	-	□	//	⊥	
	to 6	over 6 to 30	over 30 to 120	over 120 to 480	over 480 to	all	over 6 to 6	over 10 to 10	over 50 to 50	over 120 to 120	all	to 5	over 5 to 30	over 30 to 120	over 120 to		
tolerance	±0.1	±0.2	±0.3	±0.5	±0.9	±0.2	±0.5	±1	1°	30'	20'	10'	0.5	0.025	0.06	0.12	0.4

UNITS	mm	SIZE	A4	SCALE	FIRST ANGLE PROJECTION	
					NAME	MRM1