

DETAIL "A"
CHAMFER
SCALE=10:1

RoHS **UNCONTROLLED DOCUMENT**

NOTES: UNLESS OTHERWISE SPECIFIED

1. COSMETIC SPECIFICATION REFER TO WI-QA-038.

IMPEDANCE (Z)			
Frequency	25 MHz	100 MHz	300 MHz
Nominal (REF)	57 Ω	125 Ω	245 Ω
Minimum	- Ω	100 Ω	- Ω

Z vs. FREQUENCY
(REF. ONLY)

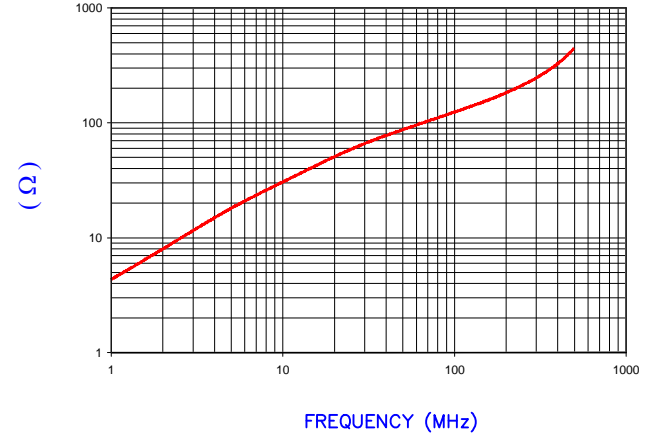

AGILENT E4991A Impedance/Material Analyzer
HP 16092A Test Fixture

BARE DIMENSIONS

A	9.53 [.375]	±	0.20 [.008]
B	5.08 [.200]	±	0.15 [.006]
C	10.41 [.410]	±	0.25 [.010]

WEIGHT/1000 2.55 kgs. 5.62 lbs.

SCALE DRAWING 1:1

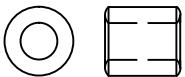

28B0375-000

DIMENSIONS ARE IN MM [INCHES].				This print is the property of Laird Tech. and is loaned in confidence subject to return upon request and with the understanding that no copies shall be made without the written consent of Laird Tech. All rights to design or invention are reserved.			
F	UPDATED COMPANY LOGO, ADD NOTE	08/29/14	QIU				
E	REV CHAMFER AND DETAIL A UPDATE LOGO	11/06/08	JRK				
D	UPDATE FORMAT & Z SPECS, ADD CURVE	05/09/03	JRK				
C	UPDATE PRINT FORMAT ADD DETAIL A	12/21/01	JRK				
B	UPDATED Z SPEC.	11/17/95	JBE				
PROJECT/PART NUMBER:				REV	PART TYPE:	DRAWN BY:	
28B0375-000				F	CNZ CORE	DJB	
DATE:				SCALE:	MATERIAL:		
11/24/92				4 : 1	Ferrite		
CAD #				TOOL #			
28B0375-000-F				B0375			
REV	DESCRIPTION	DATE	INT				