

Rev	AWO #	Description	Date	Appr
-		RELEASED	7/20/11	

APPROVED: \_\_\_\_\_  
 DATE: \_\_\_\_\_ TITLE: \_\_\_\_\_

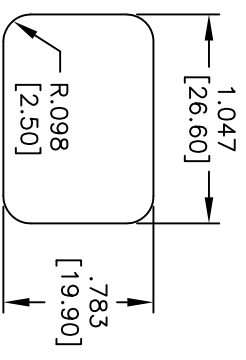
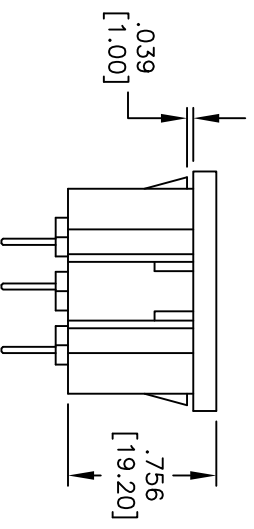
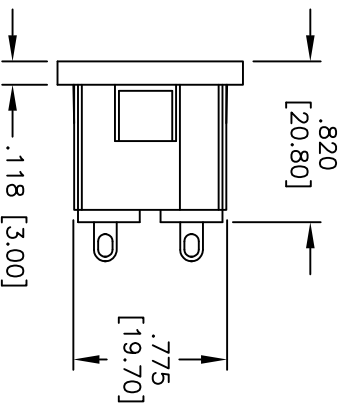
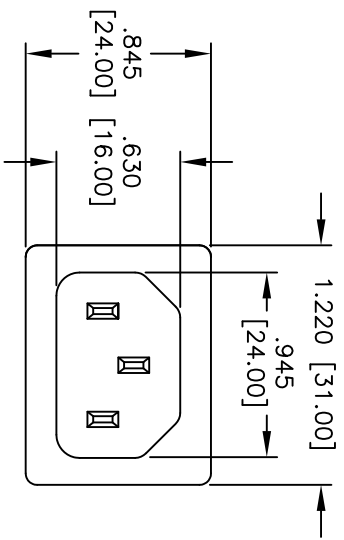

RECOMMENDED  
 PANEL CUT-OUT

**SPECIFICATIONS:**

**Material:** Nylon 66, rated UL 94V-0, black  
**Insulator:** Nylon 66, rated UL 94V-0, black  
**Contacts:** Brass, Tin plated  
**Soldering:** Brass, Tin plated  
**Electrical:**  
**Contacts Rating:** 15A(UL)/10A(VDE)  
**Voltage Rating:** 125V/250V(UL)/250V(VDE)  
**Environmental:**  
 Lead free, RoHS compliant.



UNLESS OTHERWISE SPECIFIED  
 ALL DIMENSIONS ARE MM [INCHES]  
 TOLERANCES: EXCEPT AS NOTED  
 INCHES

.X	± .10	ØXX	± .10
.XX	± .020	ØXXX	± .015
.XXX	± .015	ØXXXX	± .010
APPROVALS		DATE	
DRAWN	DY	7/20/11	
CHECKED			
APPROVED			

**ADAM TECH**

909 Rahway Avenue, Union, NJ 07083  
 Phone: 908-687-5000 Fax: 908-687-5710

IEC MALE, SNAP IN, 1.00mm PANEL

TITLE	SIZE	PART NO.	REV.
IEC MALE, SNAP IN, 1.00mm PANEL	X	IEC-C-3-100	-
REF: S0037	SCALE: NTS	SHEET 1 OF 1	