

1. Mechanical Dimensions:

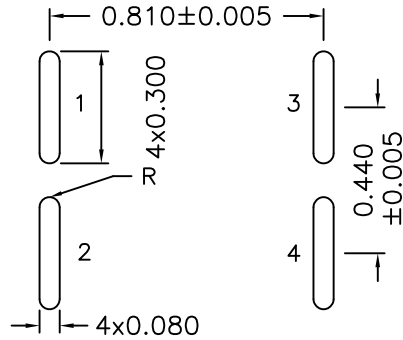

(SUGGESTED PAD LAYOUT)

2. Schematic:

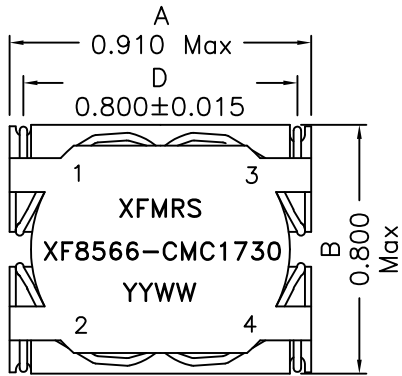
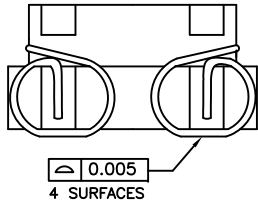
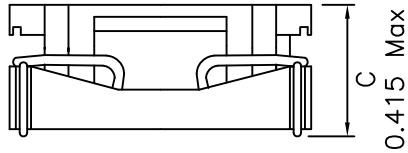
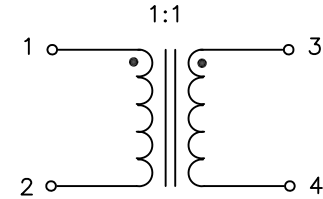

3. Electrical Specifications: @25°C

OCL: 857uH±30% @10KHz 0.1V, Each Wdg (0C to +85C)
 260uH Min @10KHz 0.1V, Each Wdg (-40C to 0C)

Q: 5.0 Min @10KHz 0.1V, Each Wdg

DCR: 0.015 Ohms Max, Each Wdg

Turns Ratio: (1-2):(3-4)=1.000:1.000±2%

Hipot: 1000Vac, Wdg to Wdg, 1 Sec

Notes:

1. Solderability: Leads shall meet MIL-STD-202G, Method 208H for solderability.
2. Flammability: UL94V-0
3. ASTM oxygen index: > 28%
4. Insulation System: Class F 155°C. UL file E151556
5. Operating Temperature Range: All listed parameters are to be within tolerance from -40°C to +85°C
6. Storage Temperature Range: -55°C to +125°C
7. Aqueous wash compatible
8. SMD Lead Coplanarity: ±0.004"(0.102mm)
9. Electrical and mechanical specifications 100% tested
10. RoHS Compliant Component
11. Recommended IR Reflow peak temp of 250°C Max.

DOC. REV: A/2

XFMRs Inc www.XFMRs.com	Title: COMMON MODE CHOKE		
	UNLESS OTHERWISE SPECIFIED TOLERANCES: .xxx ±0.010 Dimensions in Inch	P/N: XF8566-CMC1730	REV. A
	DWN.	Yuan	Jun-20-14
	CHK.	YK Liao	Jun-20-14
SHEET 1 OF 2	APP.	Joe Huff	Jun-20-14

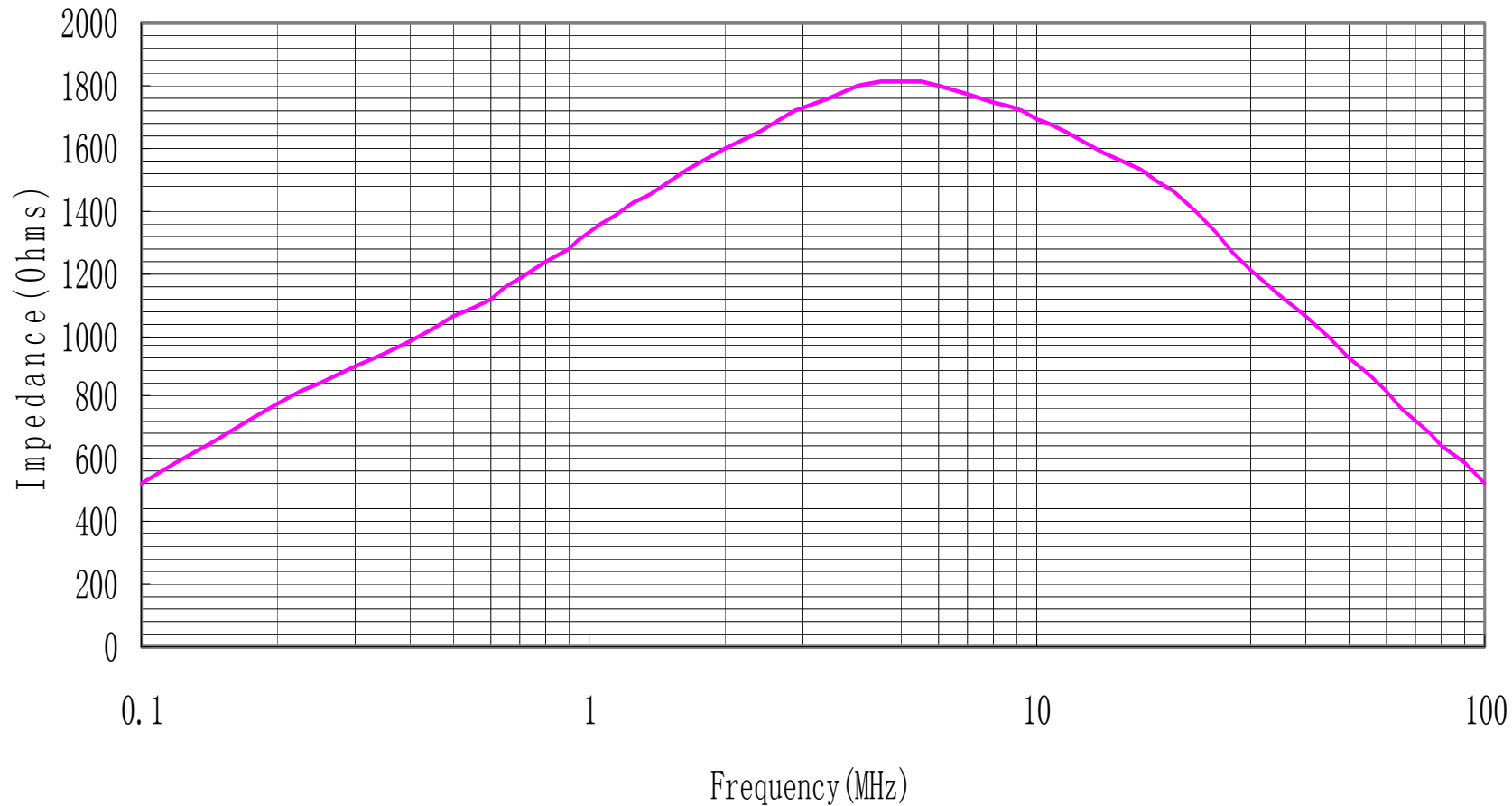

DOC. REV: A/2

XFMRs Inc www.XFMRS.com	Title: COMMON MODE CHOKE		
	UNLESS OTHERWISE SPECIFIED TOLERANCES: .xxx ±0.010 Dimensions in Inch		P/N: XF8566-CMC1730
SHEET 2 OF 2	DWN.	Yuan	Jun-20-14
	CHK.	YK Liao	Jun-20-14
	APP.	Joe Huff	Jun-20-14

PROPRIETARY

Document is the property of XFMRs Group & is not allowed to be duplicated without authorization.