

## DETAILS

<b>Product Number</b>	FS15626_FLORENCE-3R-IP-Z90
<b>Family</b>	Florence
<b>Type</b>	Assembly
<b>Color</b>	clear
<b>Diameter</b>	321 + 79 mm
<b>Height</b>	9,72 mm
<b>Style</b>	rectang
<b>Optic Material</b>	PC,Silicone
<b>Holder Material</b>	
<b>Fastening</b>	
<b>Status</b>	production ready
<b>ROHS Compliant</b>	Yes
<b>Date Updated</b>	3/01/2018



## OPTICAL PROPERTIES

LED	Viewing Angle	Light Beam	Efficiency	cd/lm	Connector
XP-E	sim: 89		sim: 91 %	sim: 0.460	-
LG 6030	90 deg		89 %	0.440	-
NVSxx19B/NVSxx19C	sim: 89		sim: 89 %	sim: 0.440	-
Oslon Square Gen3	89 deg		88 %	0.420	-
Fortimo LED Line 1ft 2000lm 8xx 3R HV278 deg			86 %	0.460	-
Fortimo LED Line 1ft 1100lm xx0 3R xV2/xx deg			87 %	0.450	-
Fortimo LED Line 1ft 650lm 8x0 3R xV2/xx deg			86 %	0.420	-

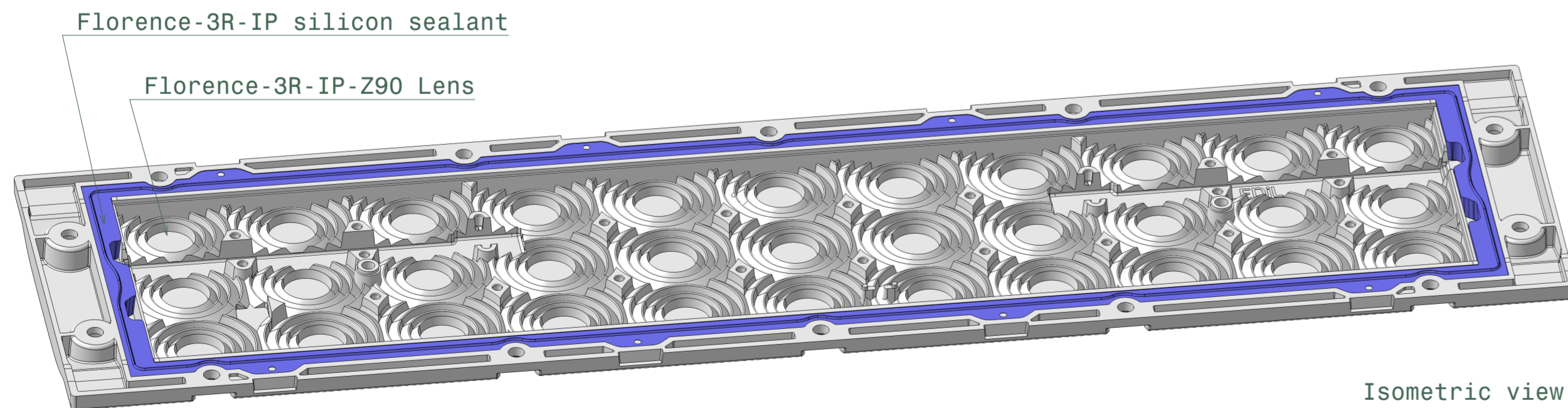
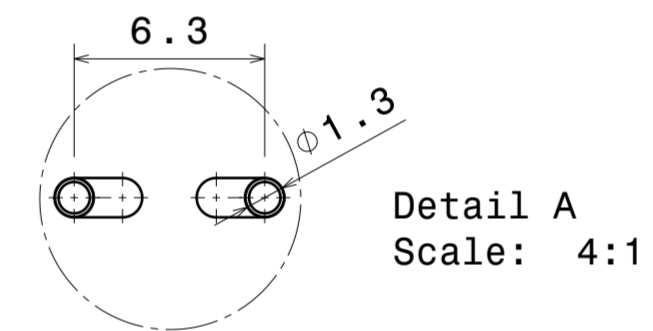
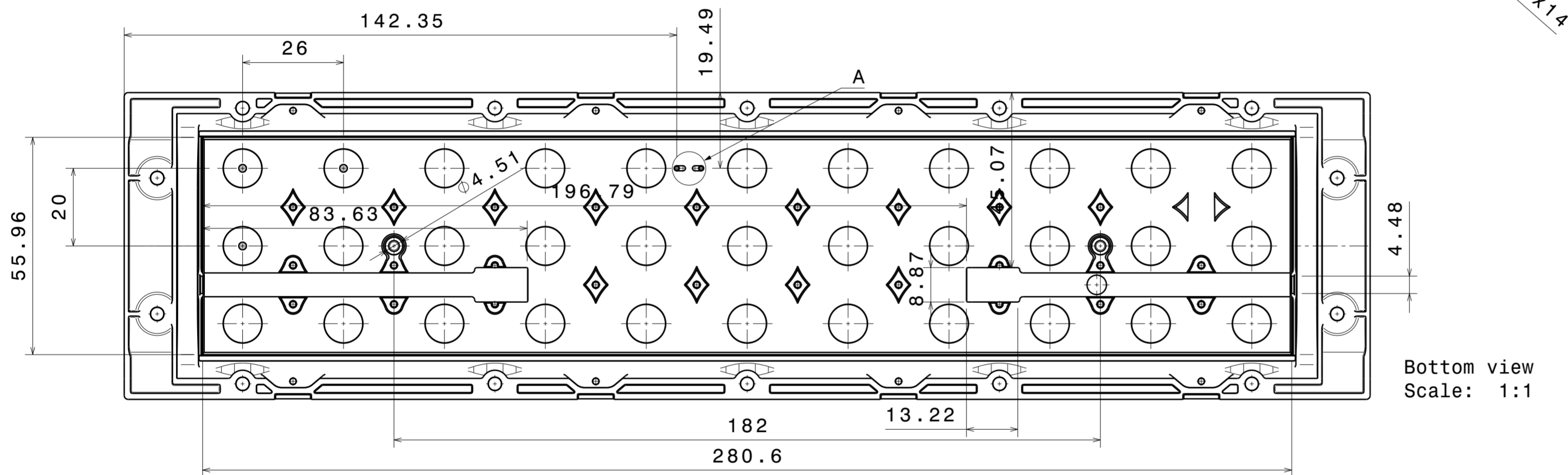
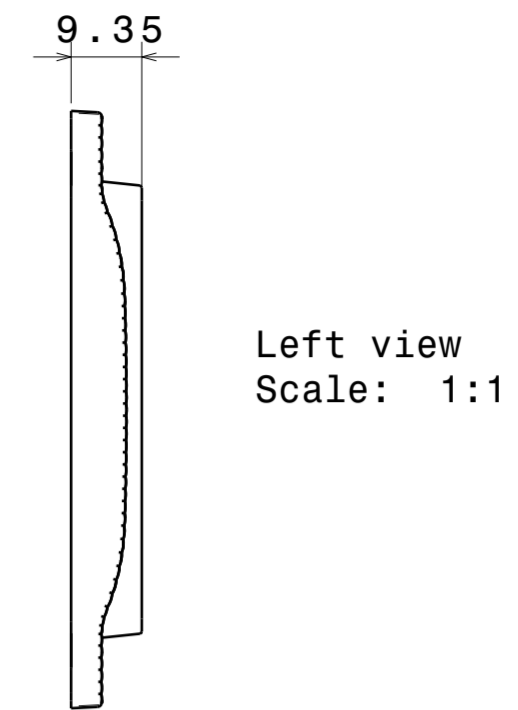
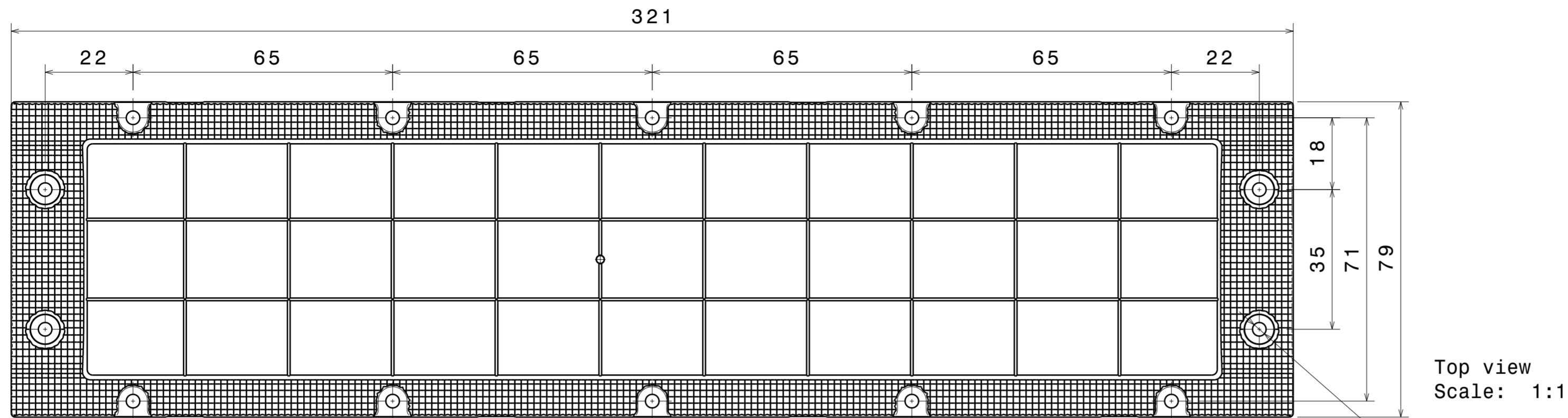

Assembly Guide F15542\_FLORENCE-3R-IP-Z90

1. Insert Silicone sealant into bottom of FLORENCE-3R-IP-Z90 lens
2. Set lens and silicone sealant on top of PCB
3. Fasten lens to heatsink with 14pcs of M3 screws

Screw type DIN 7985 M3, Max torque 0.6Nm

Tolerances if not otherwise shown According to DIN ISO 2768-1 Linear measures: Up to 30mm class M, otherwise class C. According to DIN ISO 2768-2 Form and position: class L		<b>LEDiL</b> Ledil Oy Salorankatu 10 FIN 24240 SALO Finland	
THIRD ANGLE PROJECTION:		<b>DRAWING TITLE</b> Datasheet_FLORENCE-3R-IP-Z90	
This drawing is the property of LEDiL Oy. It may not be reproduced, copied or communicated without a written agreement with LEDiL Oy.		<b>SIZE</b> A2	<b>PART NUMBER</b> F15542
		<b>SCALE</b> 1:1	<b>WEIGHT</b> g
		<b>SHEET</b> 1/1	

Luminaire: Ledil Oy FS15626\_FLORENCE-3R-IP-Z90\_(XP-E)\_SIMULATED  
Lamps: 1 x Cree XP-E

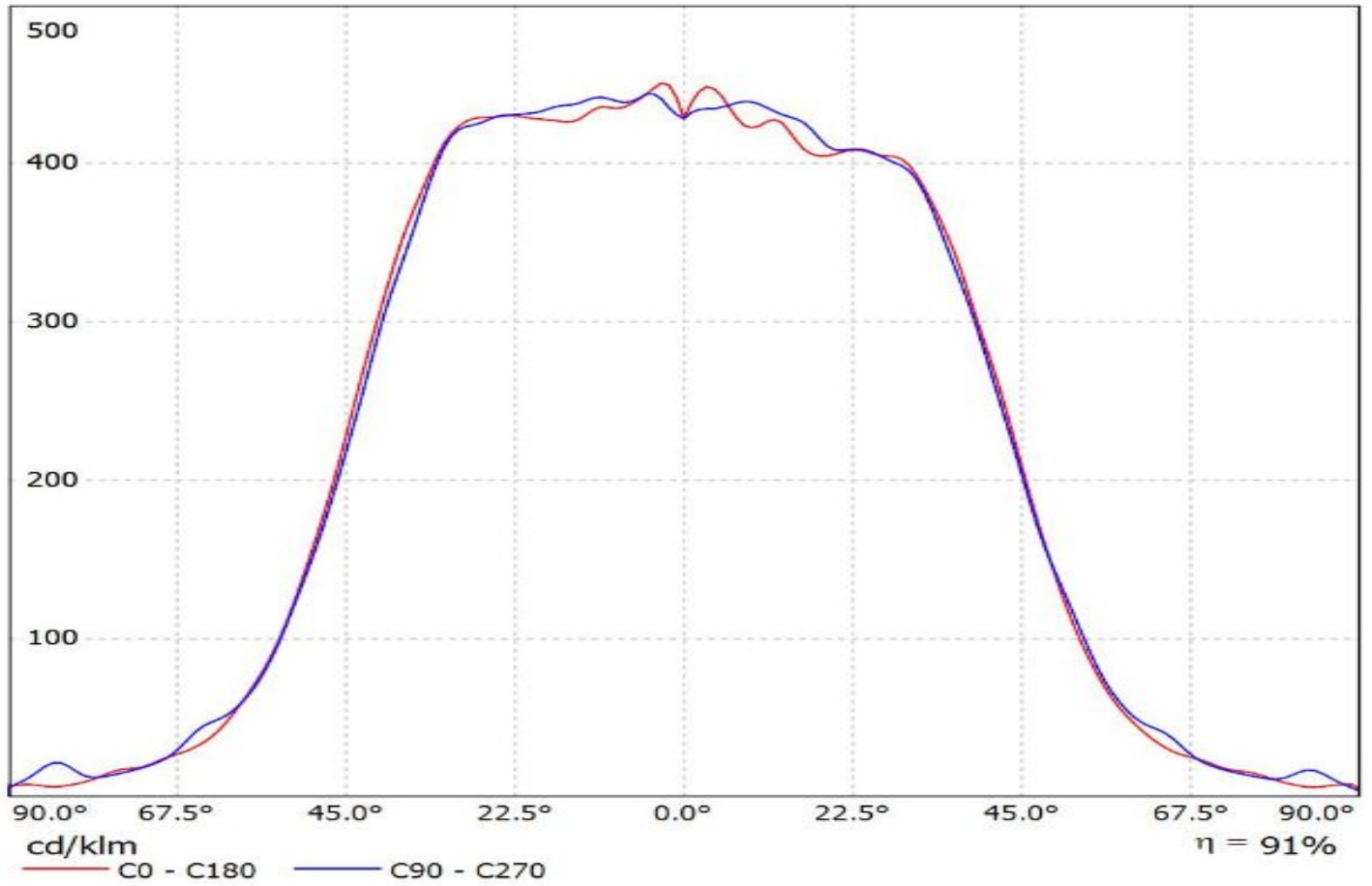

Luminaire: LEDiL Oy FS15626\_FLORENCE-3R-IP-Z90\_(LG\_6030)

Lamps: 1 x Philips\_Fortimo\_LED\_Line\_1ft\_1100lm\_840\_3R\_HV2\_(LG\_6030)\_1043.51lm@250mA\_P=7.9259W\_I=0.25A

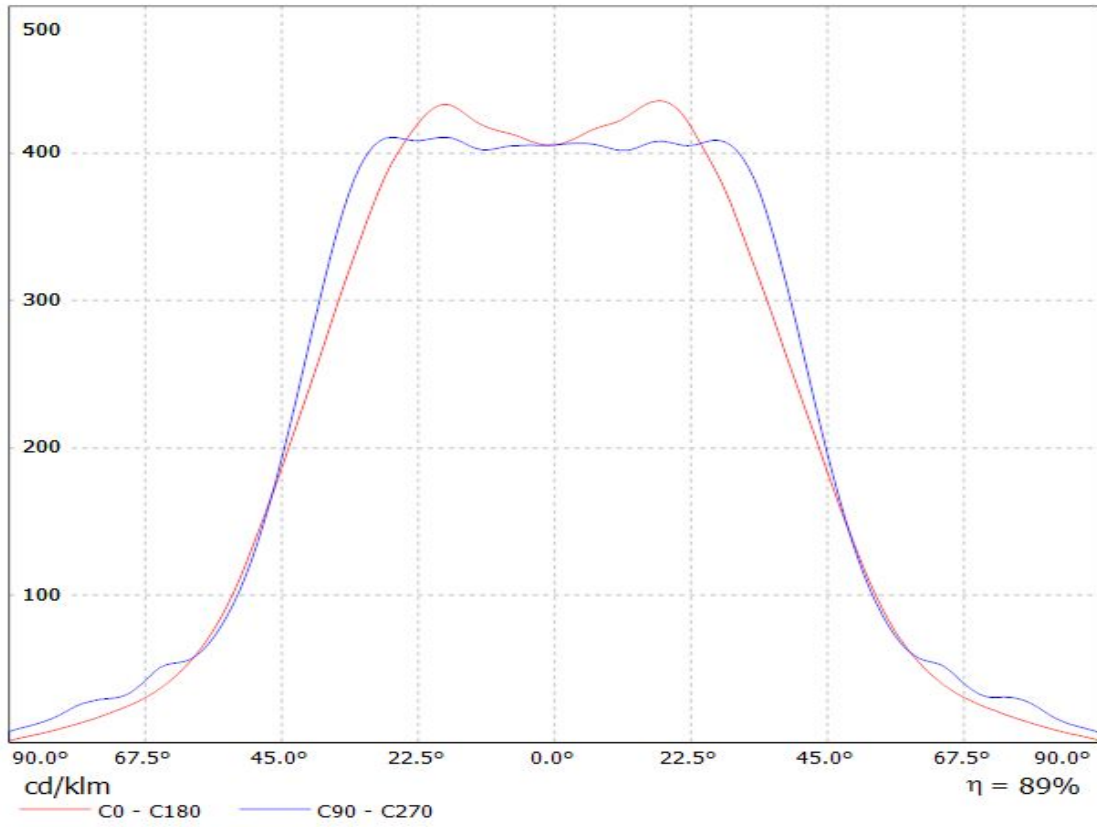

Luminaire: Ledil Oy FS15626\_FLORENCE-3R-IP-Z90\_(NVSW219C)\_SIMULATED  
Lamps: 1 x Nichia NVSW219C 5000K

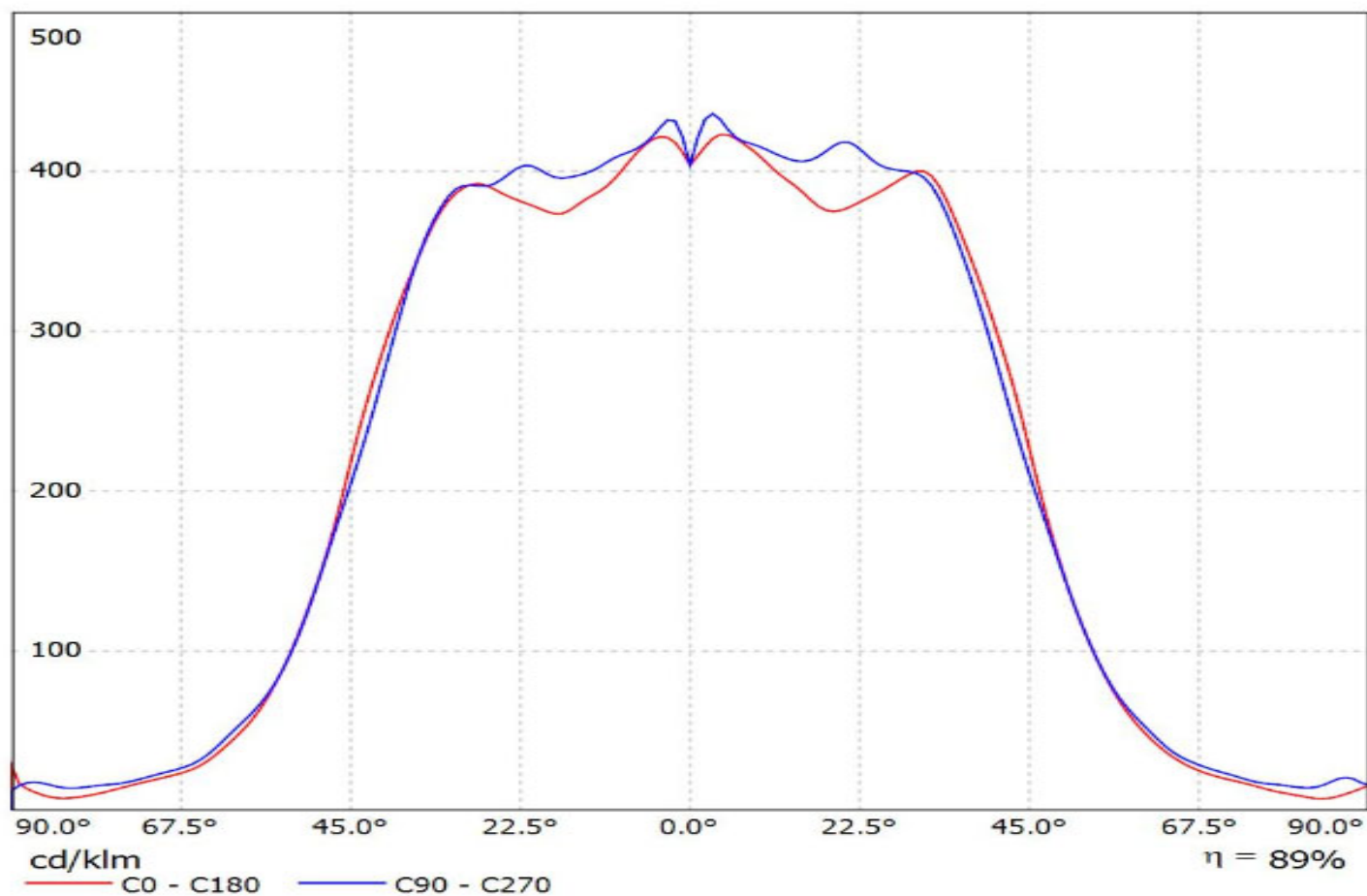



Luminaire: LEDiL Oy FS15626\_FLORENCE-3R-IP-Z90\_(Oslon\_Square\_Gen3)  
Lamps: 1 x Osram\_Oslon\_Square\_Gen3\_(GW\_CSSRM2.EM)  
\_1246.56lm@250mA\_P=7.4303W\_I=0.250A

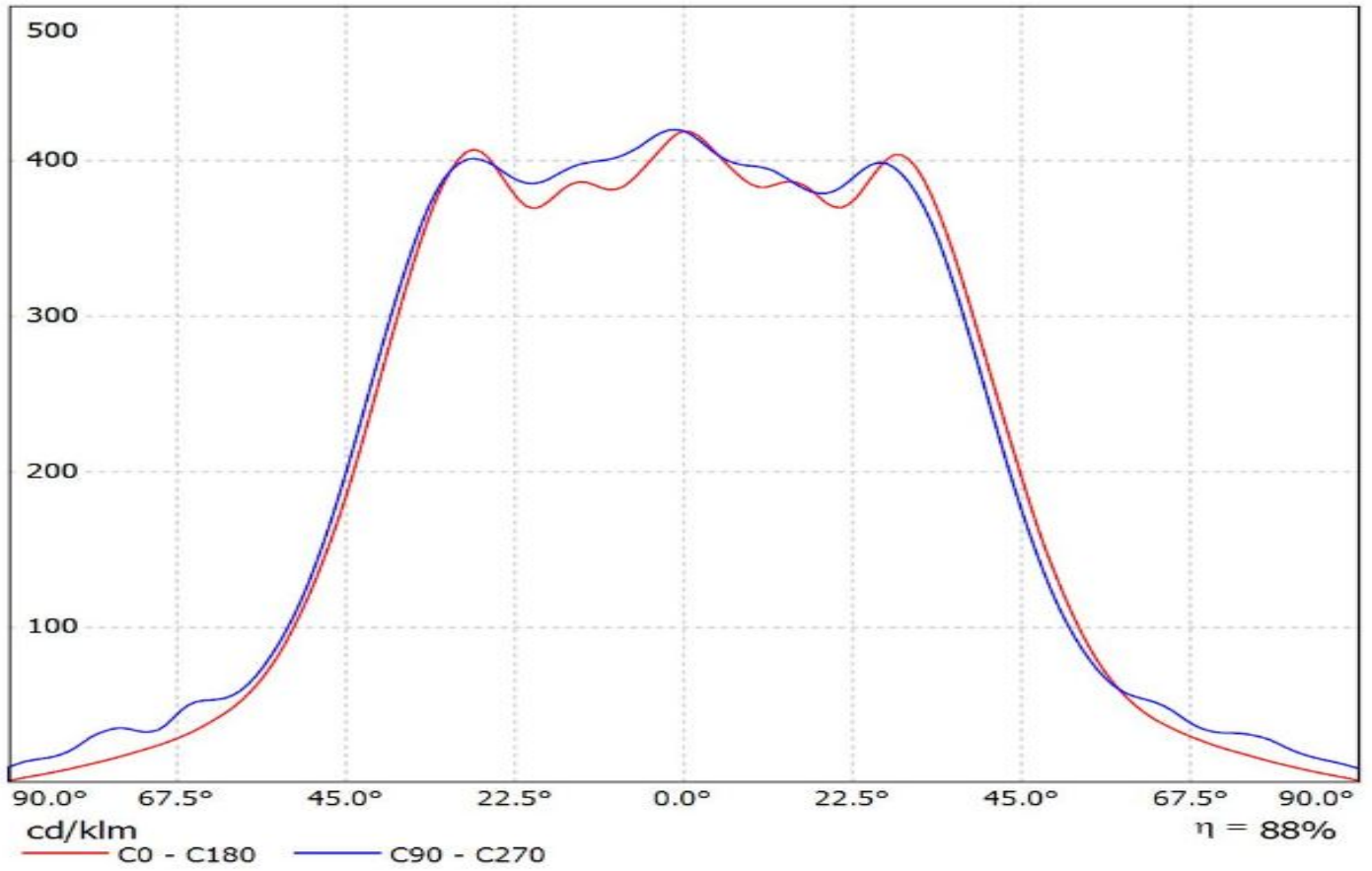

Luminaire: Ledil FS15626\_FLORENCE-3R-IP-Z90\_(Fortimo\_LED\_Line\_1ft\_2000lm\_835\_3R\_HV2)  
Lamps: 1 x Philips\_Fortimo\_LED\_Line\_1ft\_2000lm\_835\_3R\_HV2\_(LG7030)\_1226.7lm@250mA\_P=7.54023W\_I=0.250A

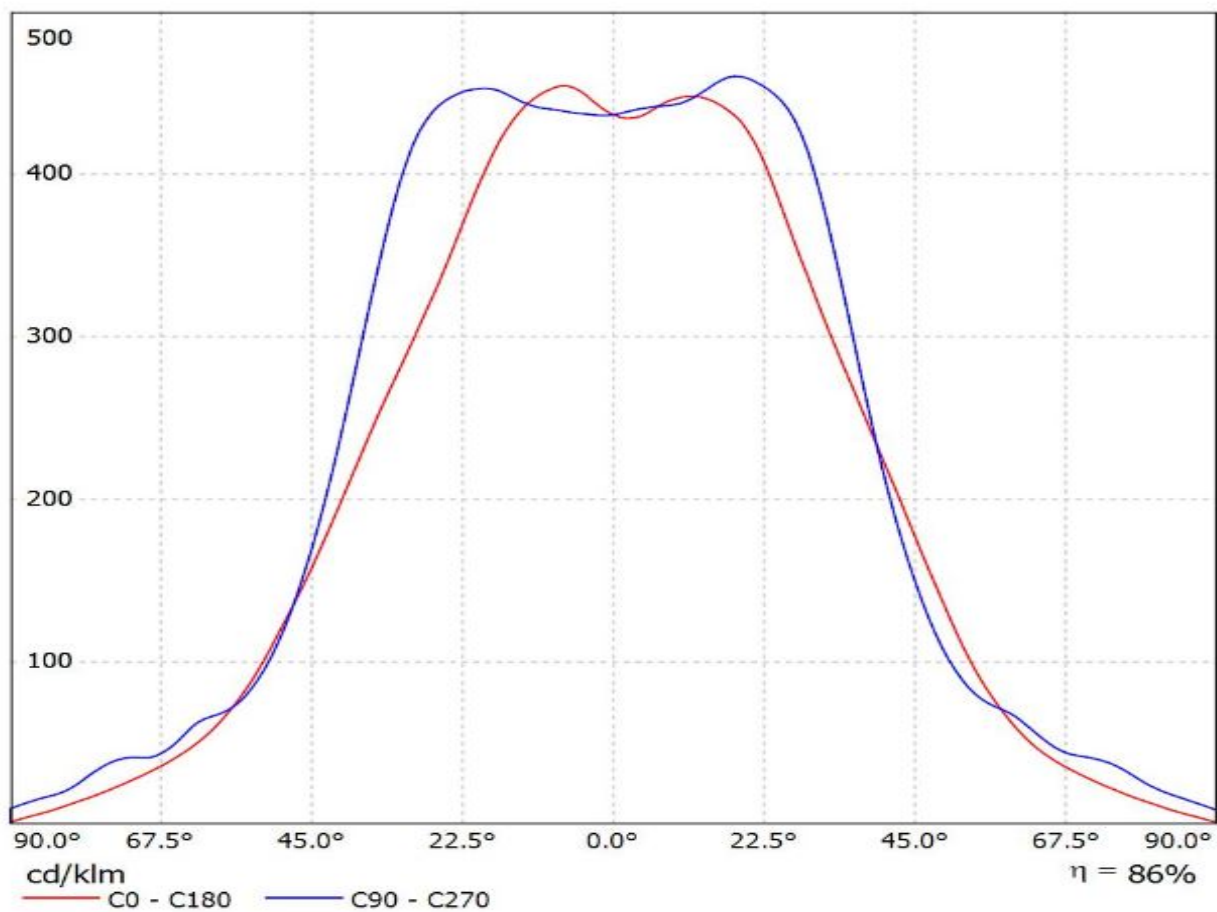

Luminaire: LEDiL Oy FS15626\_FLORENCE-3R-IP-Z90\_(Fortimo\_LED\_Line\_1ft\_1100lm\_840\_3R\_HV2)  
Lamps: 1 x Fortimo\_LED\_Line\_1ft\_1100lm\_840\_3R\_HV2\_1035.97lm@250mA\_P=7.91516W\_I=0.25A

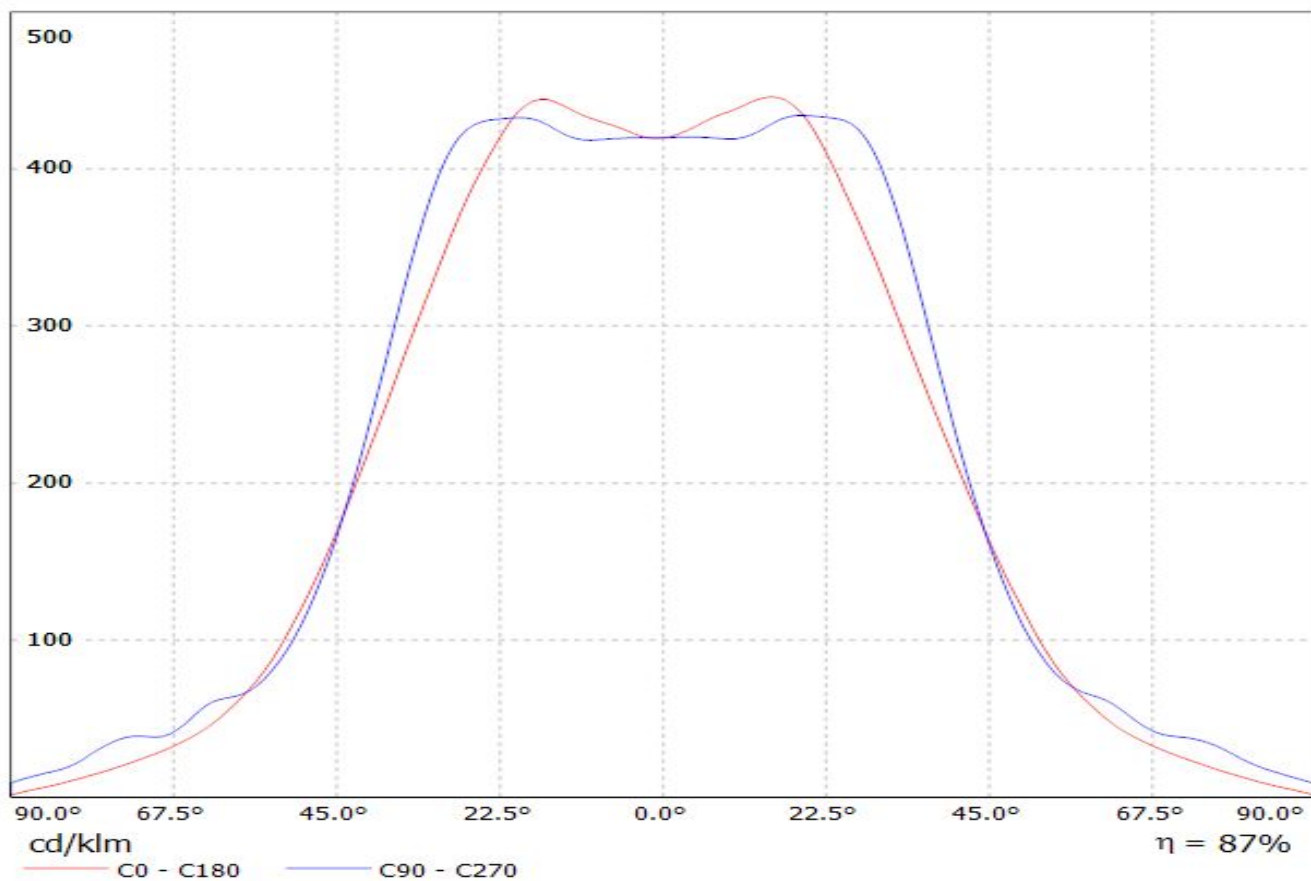



Luminaire: LEDiL Oy FS15626\_FLORENCE-3R-IP-Z90 (Philips\_Fortimo\_LED\_Line\_1ft\_650lm\_840\_3R\_LV3)  
Lamps: 1 x Philips\_Fortimo\_LED\_Line\_1ft\_650lm\_840\_3R\_LV3\_1122.62lm@250mA\_P=8.18145W\_I=0.250A

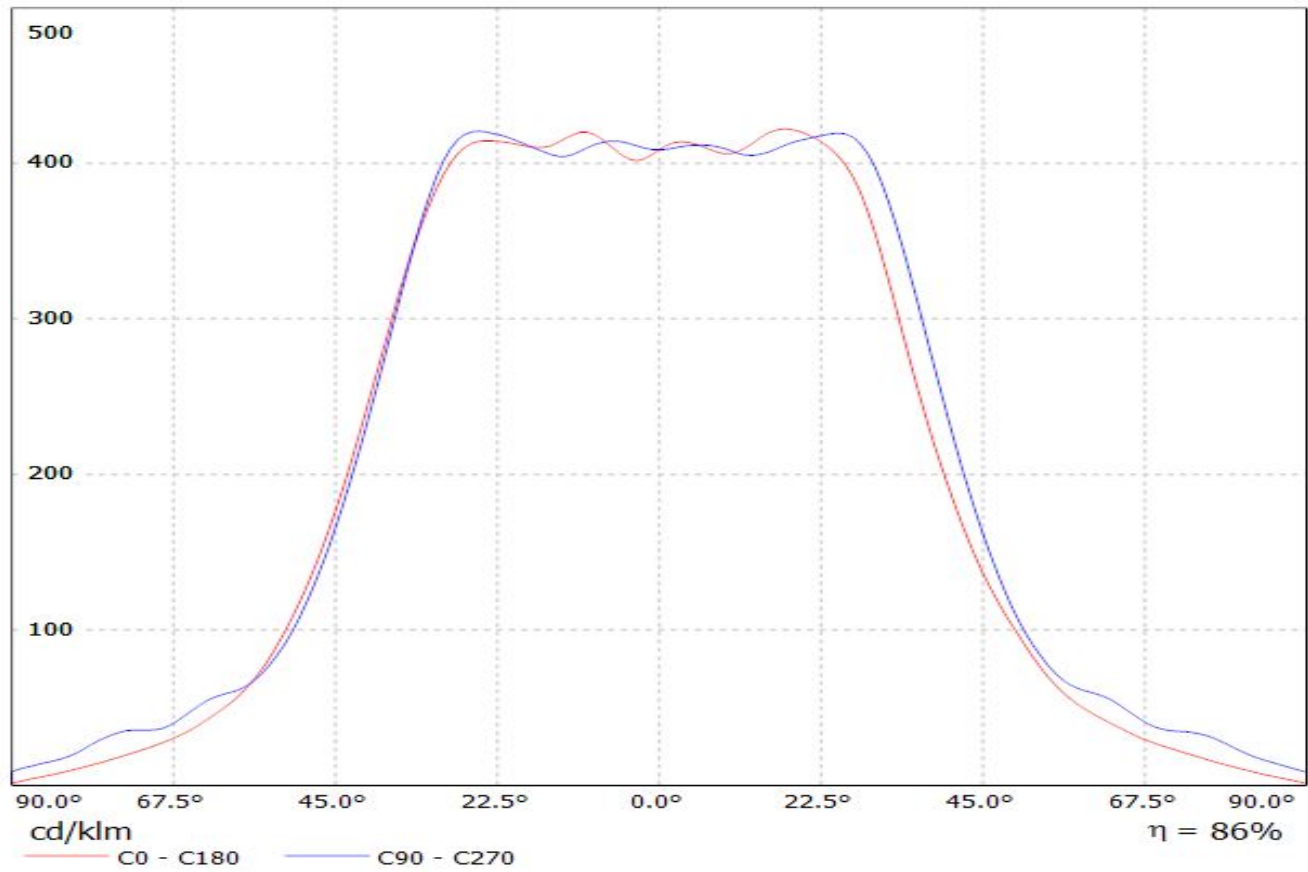

Luminaire: Ledil Oy FS15626\_FLORENCE-3R-IP-Z90\_(XP-E)\_SIMULATED

Lamps: 1 x Cree XP-E

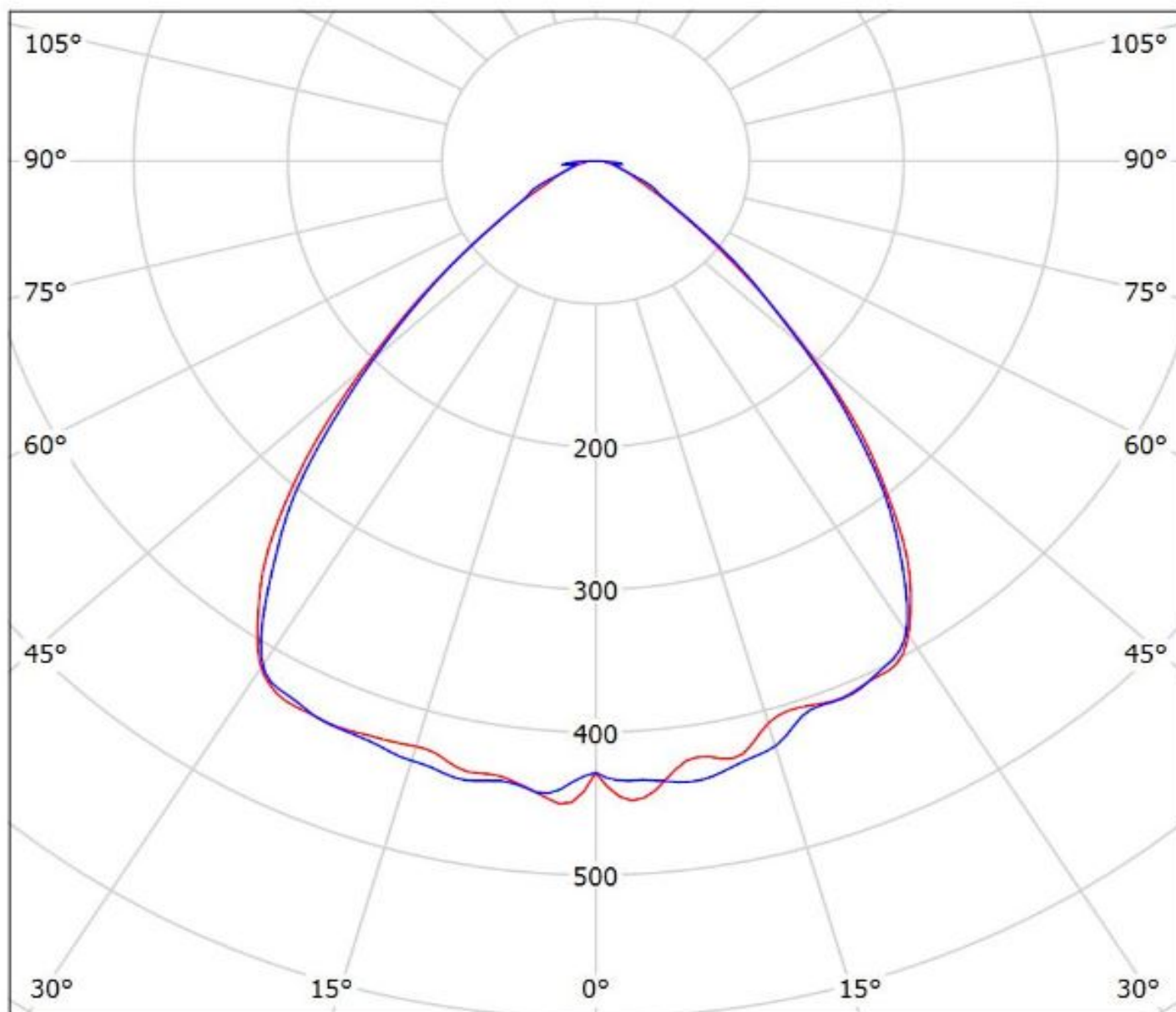

cd/klm

— C0 - C180 — C90 - C270

$\eta = 91\%$

Luminaire: LEDiL Oy FS15626\_FLORENCE-3R-IP-Z90\_(LG\_6030)

Lamps: 1 x Philips\_Fortimo\_LED\_Line\_1ft\_1100lm\_840\_3R\_HV2\_(LG\_6030)\_1043.51lm@250mA\_P=7.9259W\_I=0.25A

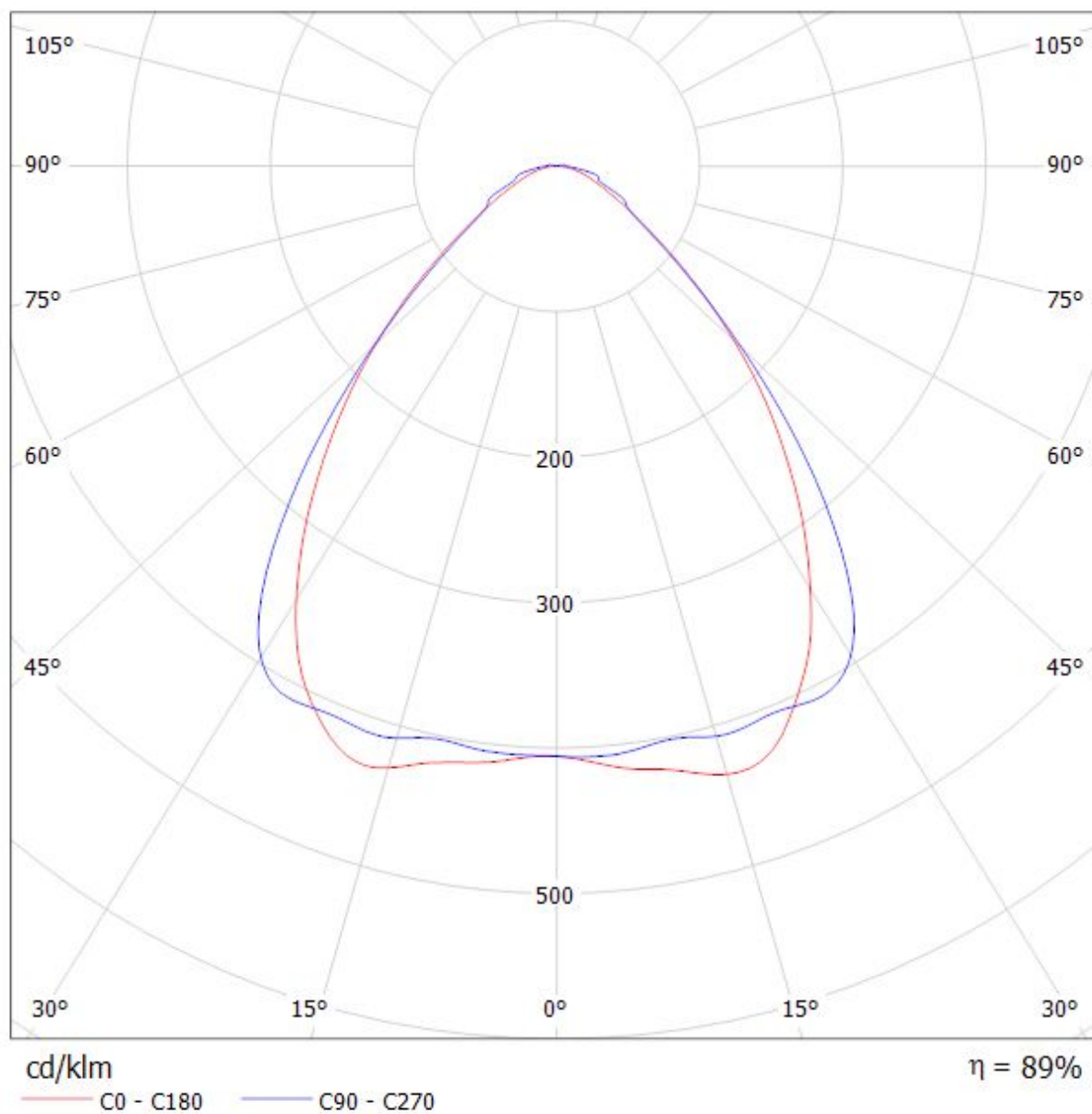

Luminaire: Ledil Oy FS15626\_FLORENCE-3R-IP-Z90\_(NVSW219C)\_SIMULATED  
Lamps: 1 x Nichia NVSW219C 5000K

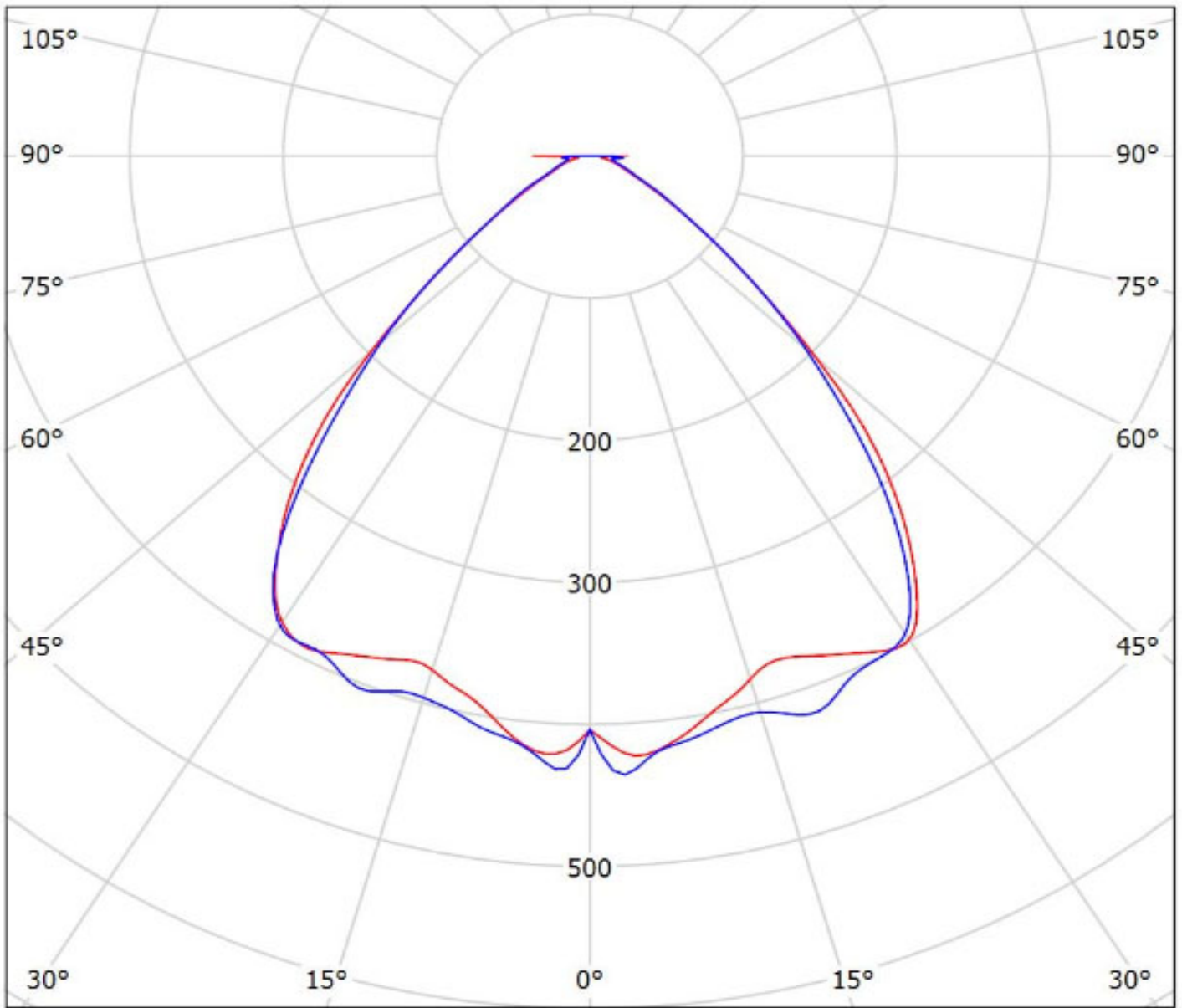

cd/klm

— C0 - C180 — C90 - C270

$\eta = 89\%$

Luminaire: LEDiL Oy FS15626\_FLORENCE-3R-IP-Z90\_(Oslon\_Square\_Gen3)  
Lamps: 1 x Osram\_Oslon\_Square\_Gen3\_(GW\_CSSRM2.EM)  
\_1246.56lm@250mA\_P=7.4303W\_I=0.250A

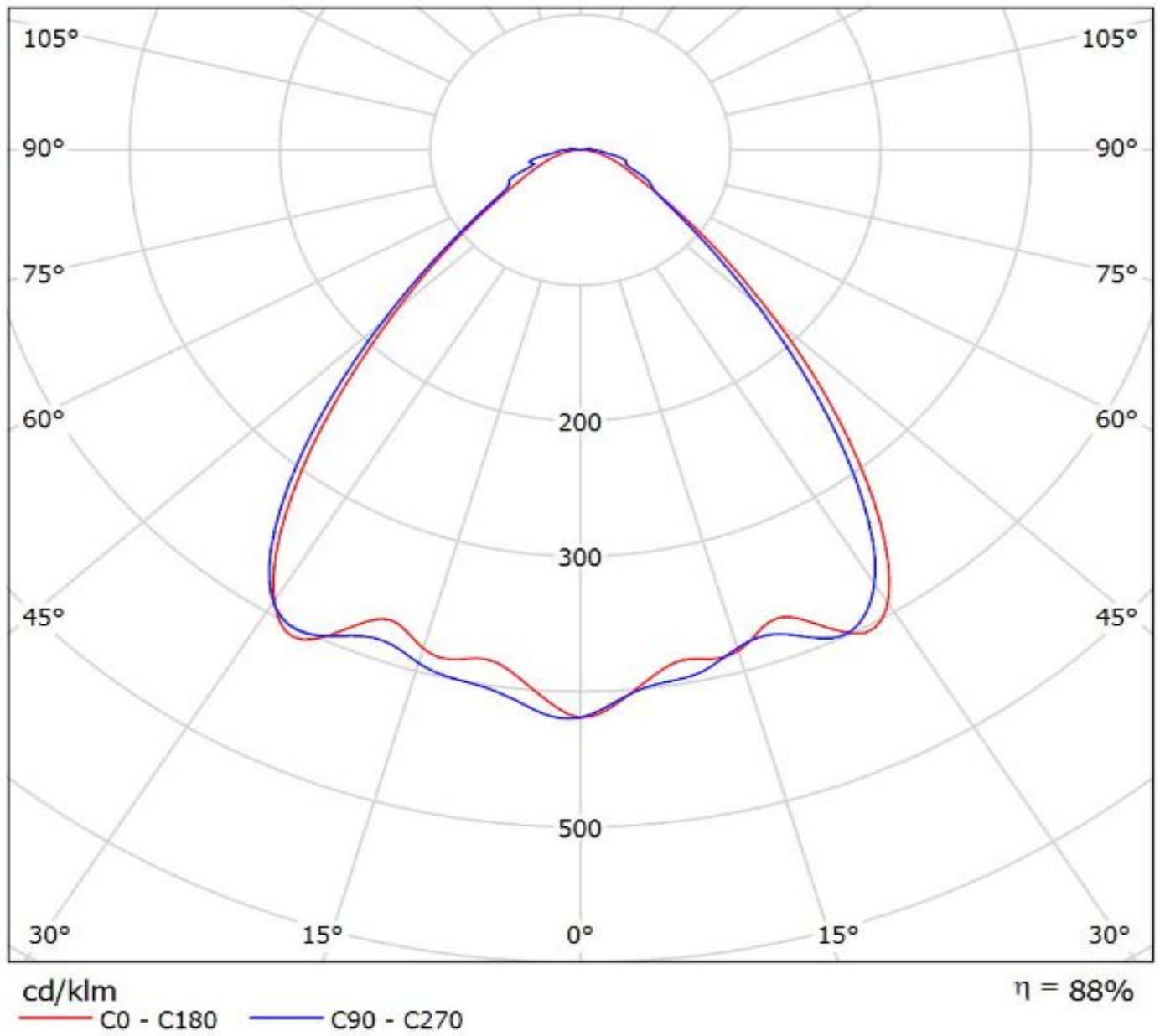

Luminaire: Ledil FS15626\_FLORENCE-3R-IP-Z90\_(Fortimo\_LED\_Line\_1ft\_2000lm\_835\_3R\_HV2)

Lamps: 1 x Philips\_Fortimo\_LED\_Line\_1ft\_2000lm\_835\_3R\_HV2\_(LG7030)\_1226.7lm@250mA\_P=7.54023W\_I=0.250A

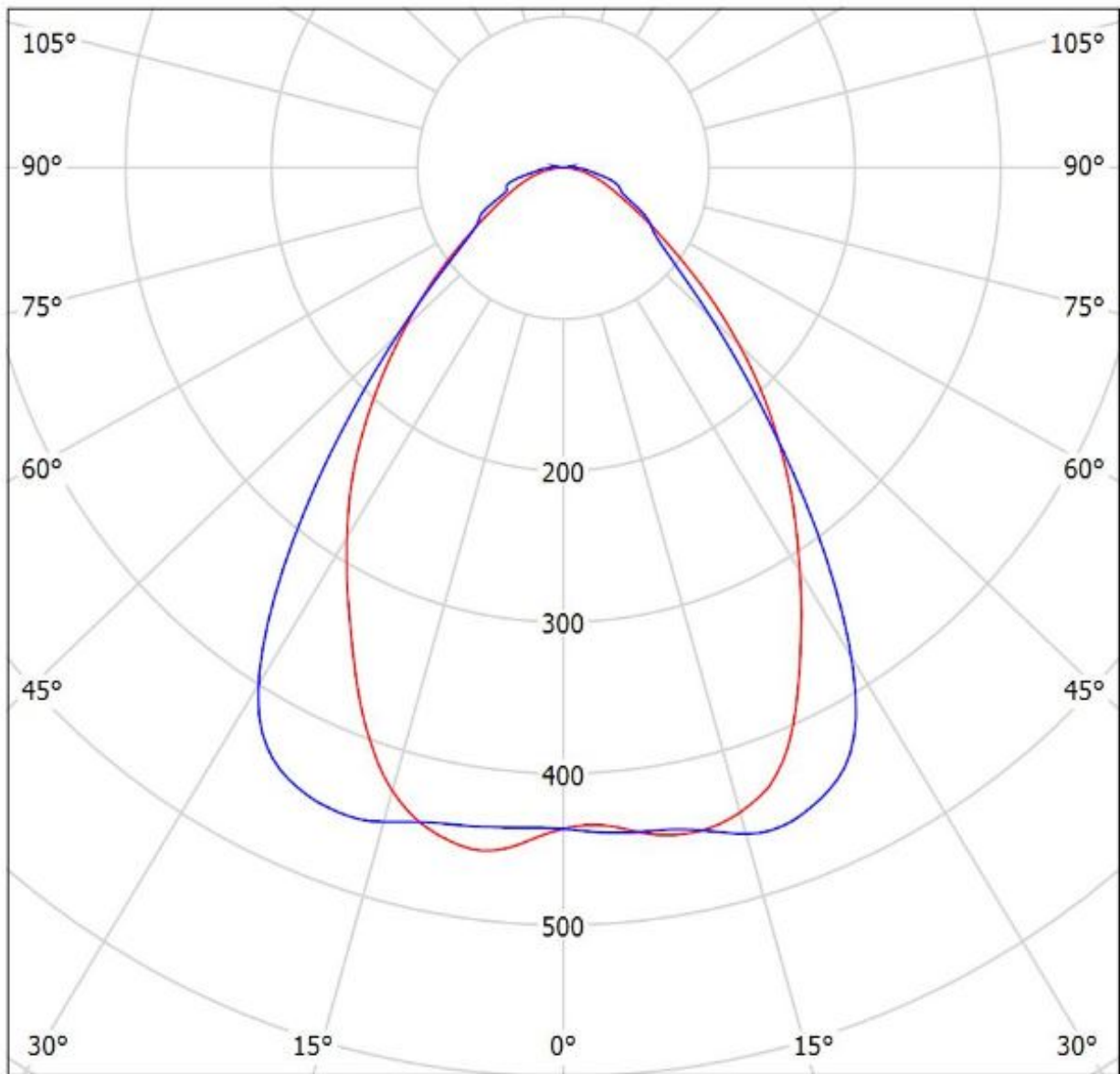

cd/klm

— C0 - C180 — C90 - C270

$\eta = 86\%$



Luminaire: LEDiL Oy FS15626\_FLORENCE-3R-IP-Z90\_(Fortimo\_LED\_Line\_1ft\_1100lm\_840\_3R\_HV2)  
Lamps: 1 x Fortimo\_LED\_Line\_1ft\_1100lm\_840\_3R\_HV2\_1035.97lm@250mA\_P=7.91516W\_I=0.25A

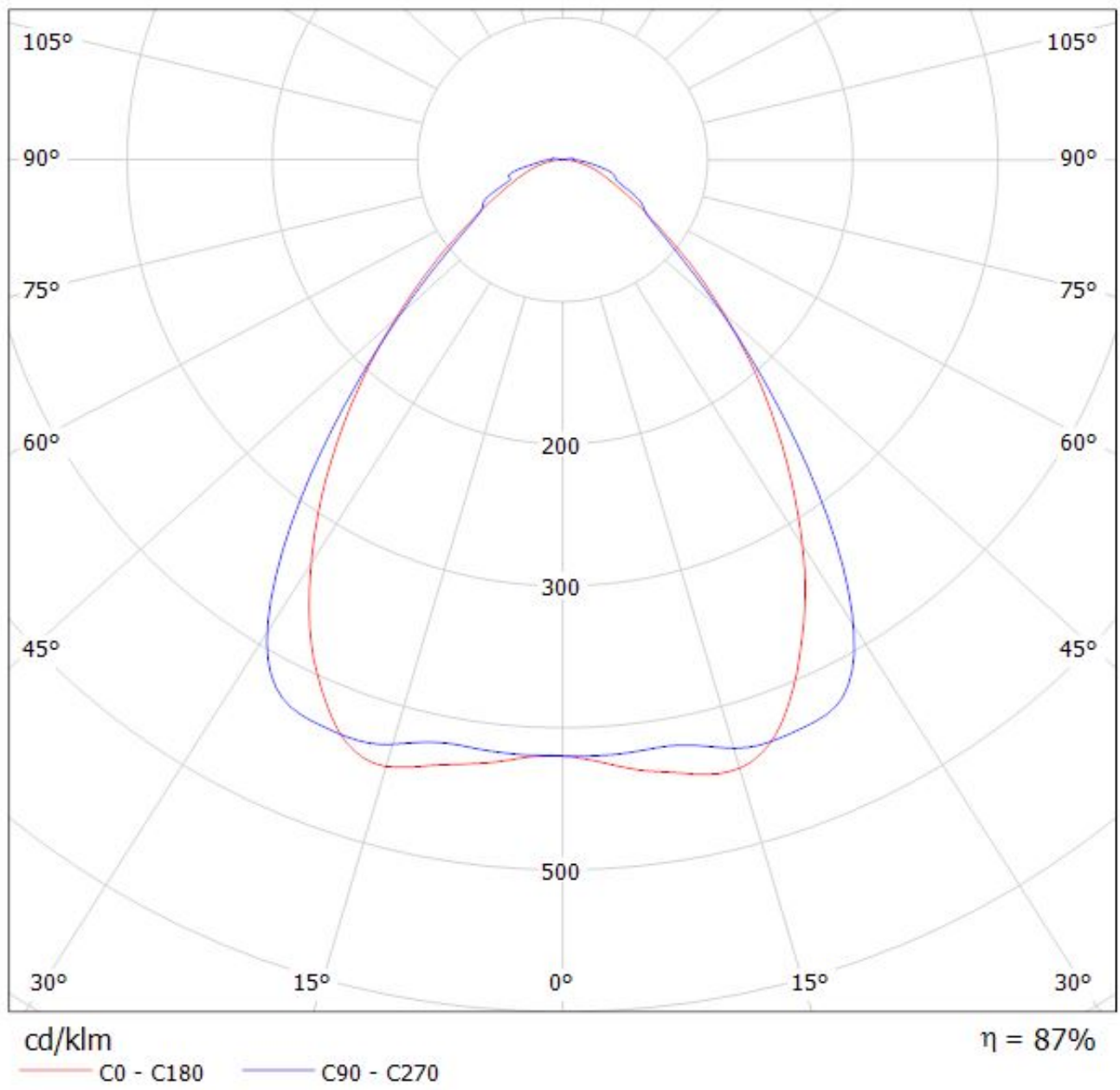

Luminaire: LEDiL Oy FS15626\_FLORENCE-3R-IP-Z90\_(Philips\_Fortimo\_LED\_Line\_1ft\_650lm\_840\_3R\_LV3)  
Lamps: 1 x Philips\_Fortimo\_LED\_Line\_1ft\_650lm\_840\_3R\_LV3\_1122.62lm@250mA\_P=8.18145W\_I=0.250A

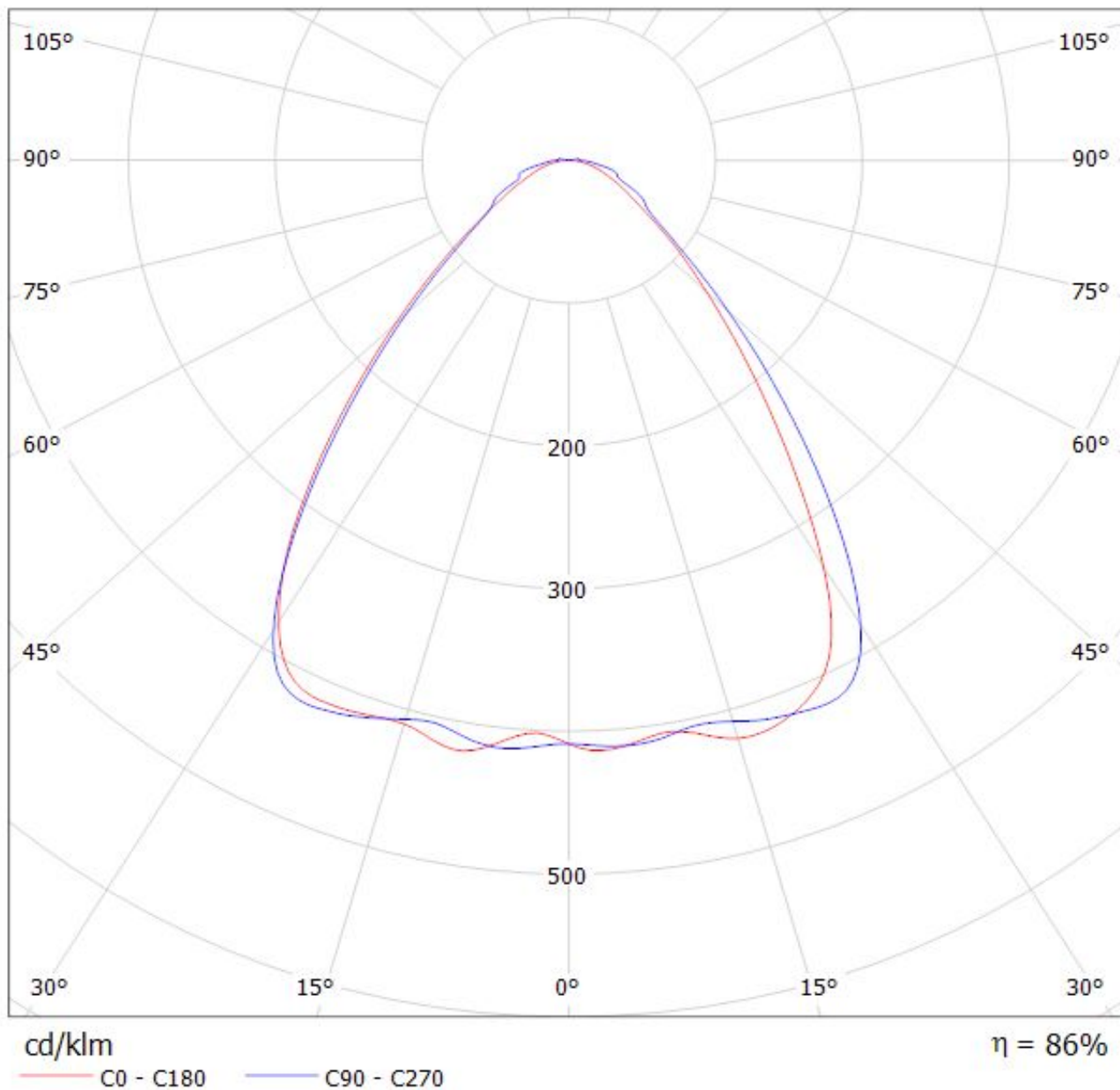

**NOTE: The typical divergence will be changed by different color, chip size and chip position tolerance. The typical total divergence is the full angle measured where the luminous intensity is half of the peak value.**